

2024 Alberta Masonry Design Awards

CELEBRATING ARCHITECTURE in MASONRY





I-XL Building Products

ixlbuild.com

**Build Without
Compromise**



**Scan QR Code and Discover
Premium Brick, Stone, and Siding**



2024 Alberta Masonry Design Awards



ACKNOWLEDGEMENTS

Planning Committee Members

Event Chair	Georgina Kostiuik, White Cap Supply Canada Inc.
Chris Ambrozic	Scorpio Masonry
Joe Black	I-XL Building Products
Sheri Blake	National Concrete Accessories
Bob Driedger	White Cap Supply Canada Inc.
Dr. Mark Hagel	Alberta Masonry Council
Lynsey Jackson	Jackson Masonry
Mike Lafontaine	Expocrete
Fraser Powell	Cast Supply Inc.
Jamie Sorenson	Ib Jensen Masonry
Delvin Ward	JKL Masonry
Darryl Williams	Timberstone Distribution

Judges

Mark Chambers
Professor Tang Lee
Bill McEwen

Professional Services

Impact Events Ltd.	Event Management
Creative Capture	Magazine Design & Graphics
Talbot Marketing	Award Plaques

Table of Contents

Message from the Chair	4
Message from Alberta Masonry Council.....	5
Sponsors	7, 8
Article: A Lifelong Bond <i>By Elizabeth Songer</i>	40

MASONRY DESIGN AWARDS

The AMC Presidential Award	6
Adhered Masonry Veneer - Commercial	9
Adhered Masonry Veneer - Residential	18
Artistic Use of Masonry	43
Commercial Building	96
Educational / Institutional.....	130
Multi Family Residential	164
Restoration	195
Single Family Residential.....	215
Structural Masonry Design	266
Sustainable Masonry Construction.....	282

ON THE COVER:

Georgian Residence, 2019 Alberta Masonry Design Awards, Presidential Award

Located in one of Calgary's oldest communities, the clients wanted a home reminiscent of Georgian architecture. Great lengths were taken in research and design to honour the characteristics and remain true to the era of the style. To truly reflect Georgian architecture, brick was cut as little as possible to resemble the craftsmanship when masonry saws were not commonplace. Heavily influenced by Calgary's historical buildings, the selection of brick colour, bond and use of stone trim were crucial to the design and important to meet the era's design standards. Sandstone was selected to complement the orange-red colour of the brick and styled to suit design elements that would have traditionally been seen, including the entryway, various accents pieces, and stone bands.



Message from the Chair

As the Chair of the 2024 Masonry Design Awards and the current Chair of the AMC, I would like to welcome you to the 2024 Alberta Masonry Design Awards. Thank you for coming. It has been an exciting and fun filled adventure working with the design awards committee, all of whom have volunteered their time to help make this event become the success that you see before you. Our esteemed panel of judges really had their work cut out for them, as we received more submissions than ever before. In fact, we had nearly 200 projects submitted, and I can guarantee you the judges had a difficult time choosing our winners. This just goes to show the amount of creativity and innovation that our architecture, design and masonry contractor community's have to offer.

When I started in this industry I didn't know a brick from a block from a rock. All I knew about masonry was from the three little pigs and how the brick house never blew down. Now just about a decade later I can't go anywhere without noticing or stopping to appreciate the masonry around me. From the extreme artistic talent and creativity all the way to a simple firewall, I need to stop, see and learn. If you think about it, masonry is as old as time, that's because in most cases it can withstand the test of time. From Ancient Mesopotamia to China's Great Wall, Egypt to France, Brazil to Mexico and across the USA. From BC to here in Alberta, Saskatchewan all the way to Labrador, the beauty of masonry is all around you.

From the structural to the aesthetic, masonry can be found and be used almost anywhere. It can be used to enhance the beauty of any design, from old world classic or country cottage to a sleek and modern look. It is used structurally, from firewalls to elevator shafts. No matter if it's a fireplace to keep you warm, a school for your children, a police station to keep you safe or a hospital to keep you healthy, there is also a use for masonry.

So, the next time you are out and about, whether you are taking a walk, going camping or traveling the world, stop and look around you, you will be amazed at all the masonry you see. Thank you to all of you, for your continued support and participation in this industry. It's your creations and hard work that add to the beauty, safety and functionality of masonry in our respective communities. I look forward to seeing all the projects that will be entered into the Masonry Design Awards at the events to come.

Georgina Kostiuk

Chair – Masonry Design Awards 2024

Chair – Alberta Masonry Council



Message from Alberta Masonry Council

The Alberta Masonry Council (AMC) would like to thank you for your support of the 2024 Alberta Masonry Design Awards. The vision of the AMC is to provide education, technical guidance and marketing to increase the awareness of the benefits of masonry, as well as promote the use of masonry and masonry products in Alberta. One way this is achieved is through events such as the Masonry Design Awards which recognizes the architects, engineers and designers who design with masonry products and the skilled craftsmen and suppliers who ensure these designs are realized. We thank you for your creativity and ingenuity!

Although masonry has been used for thousands of years, it is still used in new and exciting ways. Modern masonry has proven to be sustainable, green, carbon footprint reducing, energy efficient and adaptable. Architecture that utilizes masonry requires a great deal more skill than other materials in both design and construction. The end product is worth the effort and imparts the timeless architecture that has impressed generations around the globe for centuries.

A heartfelt thanks to you - the architects, engineers, designers, masons, and suppliers and manufacturers of masonry products in Alberta for your continued support of this amazingly versatile building material!



Executive Director,
Alberta Masonry Council
September 2024

THE AMC PRESIDENTIAL AWARD



WINDERMERE FIRE STATION NO. 31

- Owner:** City of Edmonton
Design Architect: gh3*
Architect of Record: S2 Architecture
Structural Engineer: RJC Engineers
General Contractor: PCL Construction
Masonry Contractor: Prestige Masonry Inc.
Masonry Supplier: I-XL Building Products

The Windermere Fire Station is a paragon of environmental sustainability and striking civic architecture. Key features of the design, the peaked roof and unique masonry, echo the historical context of fire stations nestled in residential neighborhoods. The exterior brick cladding evokes a distinct stature and gravitas while also allowing play of scale. The sculptural opportunities of brick are apparent in the switch at the window datum from a regular bond to an open, woven pattern. The latter provides visual texture and makes the most of the vibrant Alberta sunshine and intense Prairie shadows. This material approach enables a simultaneous interplay between the fine-grained detail of the brick and the monumentality of the building overall. The open weave pattern gives a texture, grain and visual interest to the large surfaces that it extends across. The pitched gable facing the street is a particularly expansive area of this brick treatment and plays a prominent role in the expression of the project's primary concept, the 'pinching up' of the roof form. The subtle texturing of this area draws the eye across it and along the roofline, amplifying the importance of understanding this large, pitched form in the overall interpretation of the project. The brick is hand-laid by local masons. This was critical to the design intent where extra care had to be paid to achieve the distinctive sweep of the gable, and other custom details windows, entrances and firefighter's patio.

SPONSORS

PLATINUM

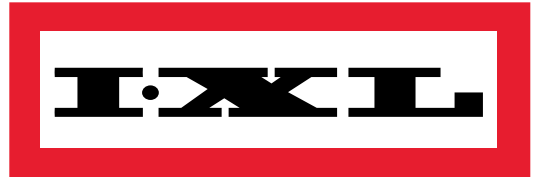

GOLD



SPONSORS

GOLD - continued



SILVER

Basalite Concrete Products ULC ■ Block-Tech Industries

Canadian Stone Industries ■ FERO Corporation ■ Gillis Quarries

Glen-Gery Brick ■ Hebron Brick ■ Ib Jensen Masonry ■ Interstate Brick

JKL Masonry ■ JR Masonry Western ■ Mayzes Masonry

Northcan Construction Ltd. ■ Oskar Construction

Rundle Rock Building Stone ■ Thunderstone Quarries

Timberstone Distribution ■ Titan Masonry

Westlake Royal Stone Solutions ■ YEG Masonry

AWARD OF EXCELLENCE – PLATINUM

ADHERED MASONRY VENEER - COMMERCIAL



REVILLON BOARDWALK INTERIOR

Owner: Allied Properties REIT

Designer: Dialog

General Contractor: PCL Construction Management Inc.

Masonry Contractor: Scorpio Masonry

Masonry Supplier: Cast Supply

AWARD OF EXCELLENCE – GOLD

ADHERED MASONRY VENEER - COMMERCIAL



CHRISTIE CROSSING

Owner: Dominion

Designer: S2 Architecture

General Contractor: Bird Stuart Olsen Construction

Masonry Contractor: Bearstone Ex Masonry

Masonry Supplier: I-XL Building Products

AWARD OF EXCELLENCE – SILVER

ADHERED MASONRY VENEER - COMMERCIAL



ROXY THEATRE

Owner: Theatre Network Society

Designer: Group2 Architecture Interior Design Ltd.

General Contractor: Chandos Construction Ltd.

Masonry Contractor: Scorpio Masonry

Masonry Supplier: Cast Supply

ADHERED MASONRY VENEER - COMMERCIAL



BUFFALO PADDOCK ON BANFF AVE

Owner: Canadian Rocky Mountain Resorts

Designer: Systemic Architecture Inc.

General Contractor: Chandos Construction Ltd.

Masonry Contractor: Tanners Masonry

Masonry Supplier: Aspen Brick & Stone

ADHERED MASONRY VENEER - COMMERCIAL



CARRINGTON GREEN

Owner: Royop

Designer: Systemic Architecture Inc.

General Contractor: Ledcor Group

Masonry Contractor: Tanners Holdings

Masonry Supplier: Timberstone Distribution

ADHERED MASONRY VENEER - COMMERCIAL



JAGARE RIDGE - DEVELOPMENT AND WATERFALL FEATURES

Owner: Melcor Developments

Designer: IBI Group

Lighting: DES Engineering

Engineer: IBI Group

General Contractor: Melcor Developments

Masonry Contractor: Bombini Masonry

Masonry Supplier: Aspen Brick & Stone

ADHERED MASONRY VENEER - COMMERCIAL



MARTEL BLOCK

Designer: Systemic Architecture Inc.

General Contractor: CANA Construction

Masonry Contractor: Tanners Masonry

Masonry Supplier: Cast Supply



WHITE CAP®

**YOUR SOURCE FOR BRICK, NATURAL
STONE, MANUFACTURED STONE
AND ACCESSORIES.**

SEVEN LOCATIONS ACROSS ALBERTA.

WHITECAPSUPPLY.COM



JACKSONMASONRY.CA
INFO@JACKSONMASONRY.CA
403.829.2770

**JACKSON
MASONRY LTD.**



Rocky Mountain



Stone Supply

ON THE CUTTING EDGE
OF NATURAL STONE

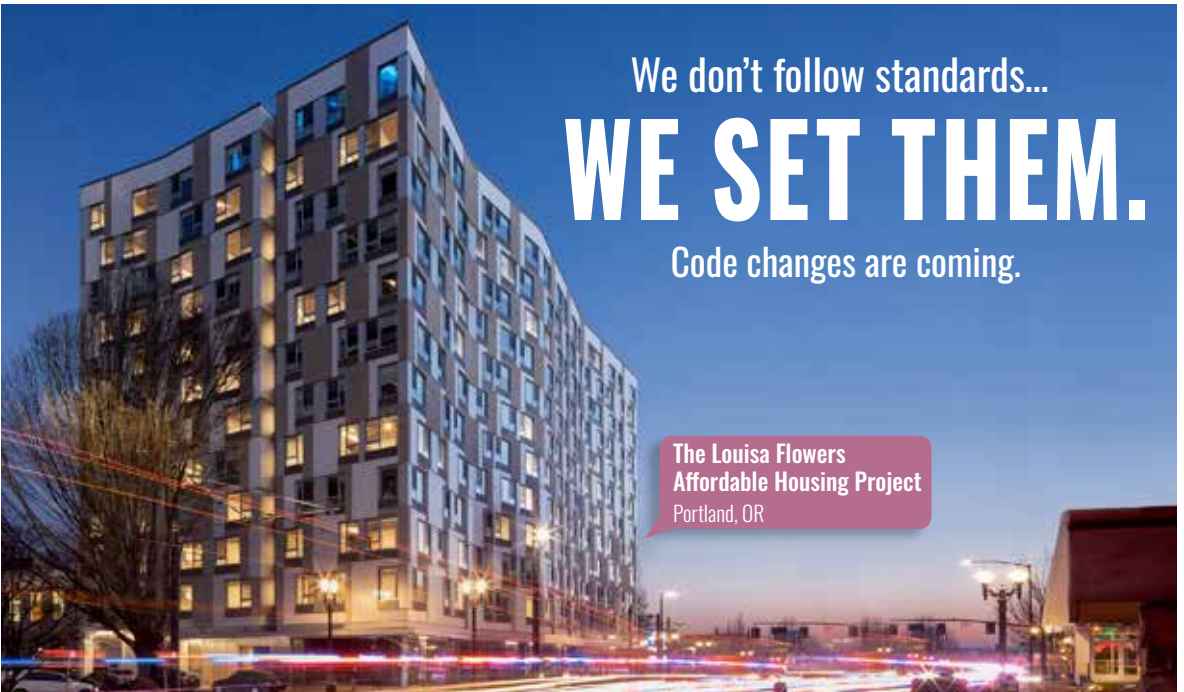

We don't follow standards...
WE SET THEM.

Code changes are coming.

The Louisa Flowers
Affordable Housing Project
Portland, OR

See how the Masonry Veneer Installation System (MVIS™)
can help you stay ahead of changing building codes



A-10406-0624 ©2024 LATICRETE International, Inc. All trademarks shown are the intellectual properties of their respective owners.

laticrete.com/TMScodechanges

AWARD OF EXCELLENCE – PLATINUM

ADHERED MASONRY VENEER - RESIDENTIAL



CATALOG HOME

General Contractor: Newground Developments

Masonry Contractor: BrickSmith Masonry

Masonry Supplier: I-XL Building Products

AWARD OF EXCELLENCE – GOLD

ADHERED MASONRY VENEER - RESIDENTIAL



PRIVATE RESIDENCE - WILDWOOD, CALGARY

Designer: Hallett Architects Ltd.

Engineer: Orata Engineering Inc.

Masonry Contractor: Jackson Masonry Ltd.

Masonry Supplier: Rocky Mountain Stone Supply

Photographer: Klassen Photography

AWARD OF EXCELLENCE – SILVER

ADHERED MASONRY VENEER - RESIDENTIAL



EDMONTON SKYLINE VIEW PROJECT

Designer: Boss Design

Interior Design: Kyle and Co Design

General Contractor: Alair Homes

Masonry Contractor: Elite Elevations Masonry

Masonry Supplier: Aspen Brick & Stone

ADHERED MASONRY VENEER - RESIDENTIAL



THE ALPINE

Designer: Boss Design

General Contractor: Hampton Homes

Masonry Contractor: YEG Masonry

Masonry Supplier: White Cap Supply Canada

ADHERED MASONRY VENEER - RESIDENTIAL



THE APOLLO AT GREENWICH

Designer: S2 Architecture

General Contractor: Cove Properties

Masonry Contractor: Jackson Masonry Ltd.

Masonry Supplier: I-XL Building Products

ADHERED MASONRY VENEER - RESIDENTIAL



CITY VIEW - HILLTOP MANOR

Designer: Graphtec Design

General Contractor: Newground Developments

Masonry Contractor: Stone Skills Masonry

Masonry Supplier: Aspen Brick & Stone

ADHERED MASONRY VENEER - RESIDENTIAL



ELVEDEN COURT

Designer: Paul Lavoie Interior Design

General Contractor: Moderno

Masonry Supplier: I-XL Building Products

ADHERED MASONRY VENEER - RESIDENTIAL



2023 FHL AVERTON

General Contractor: Averton

Masonry Contractor: Franks Masonry

Masonry Supplier: I-XL Building Products

ADHERED MASONRY VENEER - RESIDENTIAL



HANSON RESIDENCE

Owner: Hanson

General Contractor: KBM Homes

Masonry Contractor: Adorn Masonry

Masonry Supplier: White Cap Supply Canada

ADHERED MASONRY VENEER - RESIDENTIAL



HILLVIEW LOTTERY HOME

Designer: interiors by design inc

General Contractor: Hillview Master Builder

Masonry Contractor: Franks Masonry

Masonry Supplier: I-XL Building Products

ADHERED MASONRY VENEER - RESIDENTIAL



INFILL WHITE BRICK

General Contractor: Kimberly Homes

Masonry Contractor: Golden Boy Masonry

Masonry Supplier: I-XL Building Products

ADHERED MASONRY VENEER - RESIDENTIAL



LENDRUM REDEVELOPMENT

Owner: CIVIDA

Designer: Rockliff Pierzchajlo Kroman (RPK) Architects

General Contractor: Graham Construction & Engineering LP

Masonry Contractor: Scorpio Masonry

Masonry Supplier: I-XL Building Products

ADHERED MASONRY VENEER - RESIDENTIAL



LOOKOUT RIDGE

Designer: METAFOR

General Contractor: Distinctive Homes

Masonry Contractor: Oskar Construction

Masonry Supplier: I-XL Building Products

ADHERED MASONRY VENEER - RESIDENTIAL



MID TOWN - AVERTON

General Contractor: Averton

Masonry Contractor: Franks Masonry

Masonry Supplier: I-XL Building Products

Masonry: YEG masonry

ADHERED MASONRY VENEER - RESIDENTIAL



PRIVATE RESIDENCE - JARVIS BAY

Owner: Stoneworx Masonry and Stucco

Designer: Sorento Custom Homes

General Contractor: Sorento Custom Homes

Masonry Contractor: Stoneworx Masonry and Stucco

Masonry Supplier: White Cap Supply Canada

ADHERED MASONRY VENEER - RESIDENTIAL



RESIDENCES 7TH AND 7TH

Owner: Distinctive Homes

Designer: METAFOR

General Contractor: Distinctive Homes

Masonry Contractor: Oskar Construction

Masonry Supplier: I-XL Building Products

ADHERED MASONRY VENEER - RESIDENTIAL



SHERWOOD GOLF BUNGALOW

Designer: Angelique Case Interiors

Architect: Boss Design

General Contractor: Carson Built Homes

Masonry Contractor: Kontech Masonry

Masonry Supplier: Aspen Brick & Stone

ADHERED MASONRY VENEER - RESIDENTIAL



VICKY'S HOMES

Owner: Vicky's Homes

Masonry Contractor: BRK Masonry

Masonry Supplier: Timberstone Distribution

ADHERED MASONRY VENEER - RESIDENTIAL



VICTOIRE HOME

Designer: Vicky's Homes

Masonry Contractor: BRK Masonry

Masonry Supplier: White Cap Supply Canada

ADHERED MASONRY VENEER - RESIDENTIAL



THE VIEWS

Owner: Statesman Homes

General Contractor: Statesman Homes

Masonry Contractor: Am-Can Masonry

Masonry Supplier: I-XL Building Products

ADHERED MASONRY VENEER - RESIDENTIAL



WALKER LAKE APARTMENTS

Owner: Cameron Developements

Designer: Kennedy Create Architects

General Contractor: Krawford Construction Inc

Masonry Contractor: Remos Masonry

Masonry Supplier: I-XL Building Products

ADHERED MASONRY VENEER - RESIDENTIAL



WINDERMERE MANOR

Designer: Boss Design

General Contractor: Alair Homes

Masonry Contractor: Denca Construction

Masonry Supplier: Aspen Brick & Stone

A Lifelong Bond

By Elizabeth Songer, Architect AAA FRAIC

I grew up in the clay-rich mountains of East Tennessee. As a child, I saw brick everywhere: brick walkways, brick buildings downtown, brick smokestacks, brick garden walls, and of course, brick houses.



My own home was a nice mottled brick on the lower level while a beautiful blue-green layer of 60s clapboards housed the upper level. The attached garage was entirely brick as was the tall chimney that connected the floors. The brick bond itself was simple, good old running bond, but it had two smoothly curved brick screens, one that protected the recessed entry and another at the house's edge. That gave it a little flair.

I loved the brick on our house. Just by looking at the ogee screen wall, I could sense the mason's pride in his work. I touched that double-wythe wall every time I walked past it, thinking of the hands that had laid the brick and skillfully

shaped the S-curve. Other girls were enamored with the variety of clothes to dress their Barbies in; I was enamored with the variety of color and shape of all the brick in my neighborhood. I suppose I was always meant to be an architect or a mason. I stuck with architect, given that my math and drawing skills were a lot better than my back-buttering.



Even the language of brick has a playful narrative quality to it that sparked my imagination. It was easy to remember "soldiers"; they stand neatly in formation as any good serviceman would. "Sailors" take up a bit more space hoisting broad sails out on those ships of theirs. When they come to port, the sailors inevitably go to the bar with the soldiers, get into a brawl or two, and fall down on their sides, waking up with "shiners" (some occasionally needing to be carried out on a "stretcher"). Later on, when I went to college in New England, I expanded my brick vocabulary to include glazed brick and raked joints. I was thrilled to discover that many campus buildings were strewn with delightfully-named "klinkers". So many playful possibilities.

My childhood love for brick has continued into adulthood. When my future husband sent me a photo of his house in Lethbridge, I commented on the beautiful off-white and terracotta stonework below the rock dash façade. He, poor man, was hoping I would notice his carefully planted flower beds.

Our ogee wall was a double-wythe wall. The outside of our house was brick, and the inside had exposed brick too, so clearly, all brick walls were double-wythe. At 8 or 9 years of age I was horrified when my father explained that the reason we couldn't see the second wythe of brick inside the all-brick garage was because it was used strictly for protection from the elements. The structure was wood. I remember feeling I had been lied to. The brick was cheating.

Little did I know what lay ahead in the trends of brick use. A single wythe of brick is bad enough; then came thin brick. I hated it at first, but as an architect, I can appreciate the desire to keep the earth material in a project that does not have the budget for full brick.

But even worse brick injustices would cross my path. My firm led a project that was converting an entire floor of a century-old stone-faced masonry building into a large private office space. Once gutted, we found the space had many plaster and brick historic elements waiting to be appreciated. In the new design, the owner was excited to include as many of these elements as he could. He was especially excited about having the informal staff room against a wall of exposed brick. Unfortunately, in the most efficient layout, the staff room's location wasn't near any of the historic masonry. We saw just as much beauty in letting more client-driven areas of the office feel the effect of 100-year-old clay warming the room around them. Nevertheless, the client was so firmly set on having "old" brick for his staff that he ended up facing a new gypboard wall in the staff area not with thin brick, not with a brick-like ceramic tile . . . But brick wallpaper.

Masons and architects alike have seen how the persistent race to the bottom dollar distracts clients from value. When brick is replaced with vinyl, far more is lost than what is saved. Because of its durability, and likely due to humanity's ancient tradition of using it, brick conveys feelings of strength, longevity, being planted and unfaltering, being of the earth. Its material is kind to our bodies and minds: it's breathable, natural, calming, warm. Heck, it's even romantic. It's hard to make it through a Hallmark movie without seeing adorable historic brick homes in the small town where true love is about to strike.

I take pride in designing buildings that are both beautiful and functional; certainly, a building keeps the rain and cold out, but when it can do that and support more than the rudimentary needs of those inside, all the better. Beyond office and washrooms, most buildings SONGER architecture inc works on have a beating heart: a place to come together in celebration or in purpose beyond basic shelter. We use shape, light, material, and texture to encourage a specific route, create awe, or inspire curiosity. Through these tools our designs bring true functionality including the emotional effect to achieve the clients' vision. I particularly love the projects in which we have used masonry to help achieve those goals. I have tried to do my younger self proud. In fact, 8-year-old me would be thrilled to know that I also have invented my very own brick bond, known to the members of my grad school architecture studio in the 1990's as Beth Bond.

Beth Bond, like many brick bonds, was born of necessity. My class was assigned a project to design a 20x40' stand-alone building. The longer walls had to be brick; the shorter walls, fully glazed. The building was to have a concrete slab, tar and gravel roof, a small water closet, and a furnace. As a student, I was new to tar and gravel roofs, but I was excited to have brick walls. Then I learned what the building's purpose was: it was supposed to be a rehearsal and performance space for a Bösendorfer 9½ foot Concert Grand Piano.

I thought I knew brick, but having grown up in a very musical family, I definitely knew pianos, and let me tell you, the building's purpose changed everything about how I would approach this project. No self-respecting pianist would play an instrument of that quality between two parallel brick walls. My acoustician father would cover his ears in anticipation. If I kept the walls strictly as they were shown, the reflection of the sound waves would bounce off the hard brick surface and across the room repeatedly, creating a cacophony of uncontrolled sound bouncing across the room like an out-of-control rubber ball.



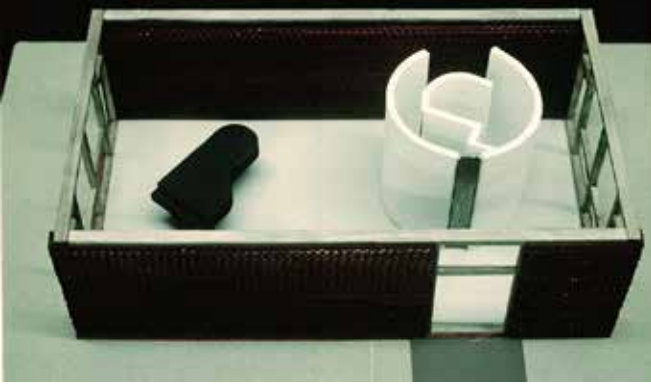

So how to stop this from happening? The assignment requirements were set. To counter the highly reflective box, I housed the mechanical and washroom in a gypsum board cylinder whose rounded surface would spread soundwaves rather than reflect them straight back.

I realized I had one more factor I could control: the brick. Unlike the disappointing garage facades of my childhood, these were true double-wythe walls, which gave me some room to play. I considered calling for raked joints and scored bricks, or even using klinkers to further break up the sound. Any of these measures would have helped to dissipate the soundwaves and reduce the reflectivity of the brick, but they wouldn't have had a big enough effect on the final quality of sound. The booming power of a Rachmaninoff sonata would have caused headaches for those trying to enjoy it; the subtleties of a Chopin nocturne would have been lost in the wash of noise bouncing back and forth between the walls. I had to find a way to break up the sound and hinder the reverberation time which would surely overpower the space.

To do this, I played with the orientation of my beloved brick. I turned every brick on its head, well on its corner, with every brick set at 45 degrees, turning the walls into vertical seas cresting with terracotta waves. The humble brick, simple enough that even a child could grasp its shape, was the secret ingredient in an elegant architectural solution to a challenging acoustic problem. Beth Bond was born.

I left the Smoky Mountains long ago and now live near the Rocky Mountains in Lethbridge, in that house with the off-white and terracotta stonework below the rock dash façade and, yes, carefully planted flower beds. My new home is close to clay deposits, and this proximity shows in the brick buildings that Lethbridge boasts. I have had the privilege to shape some of the most iconic brick buildings of my city. Nothing beats the versatility of a simple chunk of clay. ■

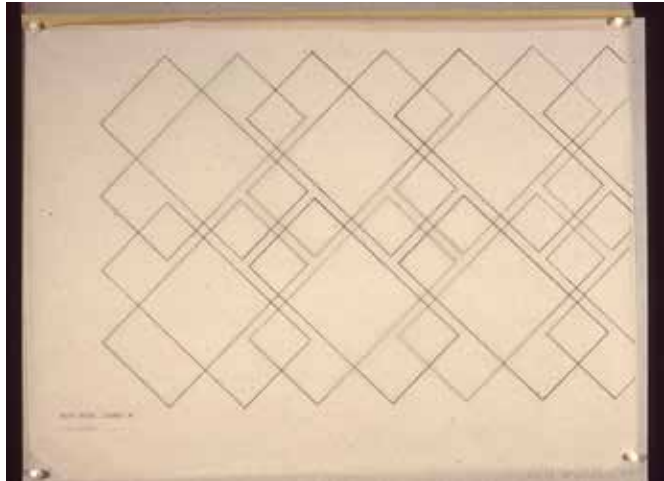

AWARD OF EXCELLENCE – PLATINUM

ARTISTIC USE OF MASONRY

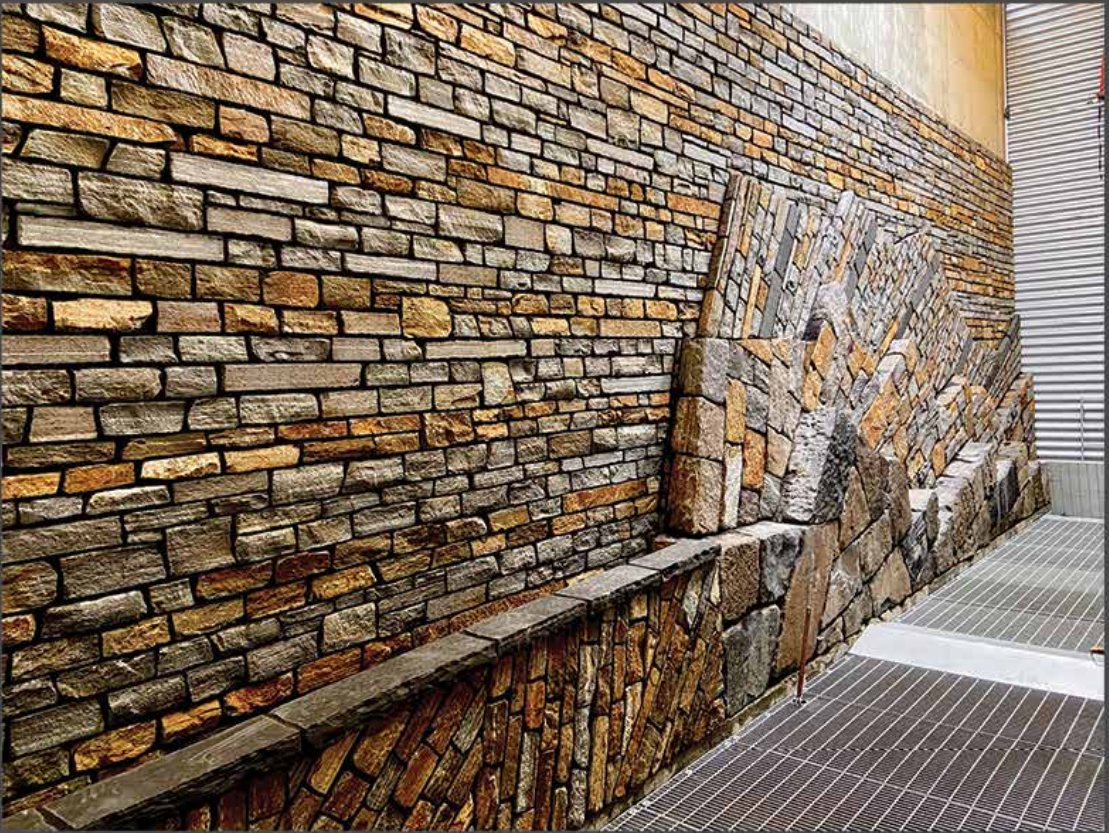

CALGARY CANCER CENTRE - LIGHT WELLS

Owner: Alberta Health Services

Designer: Dialog

Engineer: Stantec Consulting

General Contractor: PCL Construction Management Inc.

Masonry Contractor: Ib Jensen Masonry Ltd

Masonry Supplier: White Cap Supply Canada

AWARD OF EXCELLENCE – GOLD

ARTISTIC USE OF MASONRY



STRATHEARN RESIDENCE

Designer: Joe Tkalcic

Masonry Contractor: BrickSmiths Masonry

Masonry Supplier: Cast Supply Inc.

AWARD OF EXCELLENCE – SILVER

ARTISTIC USE OF MASONRY



PRIVATE RESIDENCE - POSTHILL, CALGARY

Designer: Inertia Residential Design

Designer: Elevate Design + Projects Inc.

Engineer: Silver Tree Structural Ltd.

Masonry Contractor: Jackson Masonry Ltd.

Masonry Supplier: I-XL Building Products

Photographer: Klassen Photography

ARTISTIC USE OF MASONRY



ALTADORE PROJECT

Designer: RUFproject

General Contractor: Plaid Shirt Ltd.

Masonry Contractor: Am-Can Masonry

Masonry Supplier: White Cap Supply Canada

ARTISTIC USE OF MASONRY



ARTISTIC USE OF MASONRY AT THE MATCO RANCH

Owner: Ron Matheson

Designer: Gordon White

Designer: Matco Ranch

Engineer: Gordon White

General Contractor: Gordon White

Masonry Contractor: Gordon White

Masonry Supplier: Matco Ranch

ARTISTIC USE OF MASONRY



BEL-AIRE CONTEMPORARY

Designer: Dda Architecture Ltd.

Engineer: ISL Engineering

General Contractor: Waterford Homes Inc.

Masonry Contractor: Stonehouse Masonry

Masonry Supplier: Cast Supply (Brick)

Stone Supplier: Rocky Mountain Stone Supply

ARTISTIC USE OF MASONRY



BEL-AIRE RESIDENCE

Designer: Dda Architecture Ltd.

Engineer: ISL Engineering

General Contractor: Waterford Homes Inc.

Masonry Contractor: Stonehouse Masonry

Masonry Supplier: Rocky Mountain Stone Supply

ARTISTIC USE OF MASONRY



BLUEBIRD WOOD-FIRED RESTAURANT

Owner: Banff Hospitality Collective

Designer: Frank Architecture

Interior Designer: Little Giant Studios

Engineer: RJC Engineering

General Contractor: Ellis Don

Masonry Contractor: Oskar Construction

Masonry Supplier: Thunderstone Quarries

ARTISTIC USE OF MASONRY



BRITANNIA RESIDENCE

Designer: Dda Architecture Ltd.

Engineer: KTA Structural Engineers Ltd.

General Contractor: Triangle Enterprises Ltd.

Masonry Contractor: Tanners Masonry

Masonry Supplier: Rocky Mountain Stone Supply

ARTISTIC USE OF MASONRY



BRITANNIA TYNDALL STONE CUSTOM HOME

Designer: Hallett Architects Ltd.

Stone and Exterior Fireplace Design: Corse Construction Inc.

Engineer: H.D. Richardson & Associates Ltd.

General Contractor: Corse Construction Inc.

Masonry Contractor: LMent Stone Ltd

Masonry Supplier: White Cap Supply Canada

ARTISTIC USE OF MASONRY



BUFFALO PADDOCK ON BANFF AVE

Owner: Canadian Rocky Mountain Resorts

Designer: Systemic Architecture Inc.

General Contractor: Chandos Construction Ltd.

Masonry Contractor: Tanners Masonry

Masonry Supplier: Aspen Brick & Stone

ARTISTIC USE OF MASONRY



CANADIAN BRICK INFILL

Designer: Heirloom Homes

General Contractor: Heirloom Homes

Masonry Contractor: DMG Masonry

Masonry Supplier: Aspen Brick & Stone

ARTISTIC USE OF MASONRY



544 CRESCENT ROAD NW

Masonry Contractor: Tanners Masonry

Masonry Supplier: White Cap Supply Canada

ARTISTIC USE OF MASONRY



EDMONTON CITY HALL PLAZA AND FOUNTAIN

Owner: City of Edmonton

Designer: GEC Architecture

Landscape Architect: Janet Rosenberg & Studio

Engineer: Arrow Engineering

General Contractor: Stanley Construction

Masonry Contractor: Scorpio Masonry

Masonry Supplier: A. Lacroix Granit

ARTISTIC USE OF MASONRY



ENTRY FEATURE @ SYLVAN LAKE

Designer: Bassett Associates

Engineer: General Contractor: Marmot Constructions

Masonry Contractor: Tanners Masonry

Masonry Supplier: Select Stone Supply

ARTISTIC USE OF MASONRY



FIREPLACE & WOOD BURNING PIZZA OVEN

Designer: Am-Can Masonry

General Contractor: Am-Can Masonry

Masonry Contractor: Am-Can Masonry

ARTISTIC USE OF MASONRY



GENEVIEVE E. YATES MEMORIAL CENTRE RENEWAL

Owner: City of Lethbridge

Designer: SONGER architecture inc

Engineer: Entuitive

General Contractor: Stuart Olson

Masonry Contractor: Zrim Masonry

Masonry Supplier: White Cap Supply Canada

ARTISTIC USE OF MASONRY



GEORGIAN REVIVAL HOUSE

Designer: Systemic Architecture Inc.

Interior Designer: Holland Design

Engineer: Ground3 Landscape Architect

General Contractor: Casman Group of Companies

Masonry Contractor: Tanners Masonry

Masonry Supplier: Aspen Brick & Stone

Historical Stone Supplier: Uniquities Architectural Antiques & Salvage

ARTISTIC USE OF MASONRY



THE GLENCOE GOLF & COUNTRY CLUB

General Contractor: Stuart Olson

Masonry Contractor: Tanners Masonry

Masonry Supplier: ThunderStone Quarries

ARTISTIC USE OF MASONRY



GLENRIDDING STONE BLEND

Owner: Windermere Communities Inc.
Designer: IBI Group
Masonry Contractor: Scorpio Masonry
Masonry Supplier: Aspen Brick & Stone

ARTISTIC USE OF MASONRY



GOVERNMENT OF CANADA BUILDING, COALDALE

Owner: Government of Canada (RCMP)

Designer: ACI Architecture

Engineer: BPTEC Engineering Ltd.

General Contractor: Pomerleau Inc.

Masonry Contractor: Titan Masonry Ltd.

Masonry Supplier: White Cap Supply Canada

Masonry Supplier: Expocrete

ARTISTIC USE OF MASONRY



THE GRAND ARCHES

General Contractor: Grandscape Homes

Masonry Contractor: Tanners Masonry

Masonry Supplier: Rocky Mountain Stone Supply

ARTISTIC USE OF MASONRY



HIGHLANDS SCHOOL EXPANSION AND MODERNIZATION

Owner: Edmonton Public Schools

Designer: ACI Architecture

Engineer: RJC Engineering

General Contractor: Bird Construction

Masonry Contractor: Northcan Construction Ltd

Masonry Supplier: Cast Supply

Masonry Supplier: Expocrete

ARTISTIC USE OF MASONRY



830 HILLCREST AVE CALGARY

Designer: McDowell & Associates Inc.

General Contractor: Rawlyk Developments

Masonry Contractor: Tanners Masonry

Masonry Supplier: White Cap Supply Canada

Masonry Supplier: Rocky Mountain Stone Supply

ARTISTIC USE OF MASONRY



LAC LA BICHE COUNTY WASHROOMS AND GAZEBO

Owner: Lac La Biche County

Masonry Contractor: Adorn Masonry

Masonry Supplier: Cast Supply

Masonry Supplier: Expocrete

ARTISTIC USE OF MASONRY



LAKEVIEW RESIDENCE

Designer: Dda Architecture Ltd.

Engineer: AM Structural Engineering Ltd. (House)

General Contractor: Waterford Homes Inc.

Masonry Contractor: Stonehouse Masonry

Masonry Supplier: Keel Architectural Products

Engineer Masonry: BBStek Design Ltd.

ARTISTIC USE OF MASONRY



LIGHT HORSE PARK

Owner: City of Edmonton

Designer: IBI Group

General Contractor: Stanley Construction

Masonry Contractor: Scorpio Masonry

Masonry Supplier: Cast Supply / Lacroix Granite /
Expocrete / Concrete-Inc

ARTISTIC USE OF MASONRY



LYALTA

General Contractor: Windsor & Brunello

Masonry Contractor: Tanners Masonry

Masonry Supplier: Select Stone Supply

ARTISTIC USE OF MASONRY



MANCHESTER SQUARE

Owner: 76 Group Co

General Contractor: Apex Contracting

Masonry Contractor: Scorpio Masonry

ARTISTIC USE OF MASONRY



35 MCKENDRICKS POINTE

Masonry Contractor: Tanners Masonry

Masonry Supplier: Stone Concept

Masonry Supplier: I-XL Building Products

ARTISTIC USE OF MASONRY



MCKENZIE MEWS

Owner: Cube Development Ltd.

Designer: Block Group Ltd.

Engineer: PH McNally and Associates Ltd.

General Contractor: BR Construction Inc.

Masonry Contractor: Mayzes Masonry Inc.

Masonry Supplier: I-XL Building Products

ARTISTIC USE OF MASONRY



MEADOWS MILE PROFESSIONAL BUILDING

Owner: D&P Commercial Group

Designer: Spectrum Architecture

Masonry Contractor: Titan Masonry

Masonry Supplier: I-XL Building Products

ARTISTIC USE OF MASONRY



OCEAN PEARL SLAB FIREPLACE

Designer: Boss Design

Design: Aspen Brick & Stone

Engineer: Acius Engineering

Masonry Contractor: Elite Elevations Masonry

Masonry Supplier: Aspen Brick & Stone

ARTISTIC USE OF MASONRY



OWL RIVER CAMPGROUND WASHROOMS AND GAZEBO

Owner: Lac La Biche

General Contractor: Lac La Biche County

Masonry Contractor: Adorn Masonry

Masonry Supplier: Cast Supply

Masonry Supplier: Expocrete

ARTISTIC USE OF MASONRY



POWELL RESIDENCE

Masonry Contractor: Tanners Masonry

Masonry Supplier: Thunderstone Quarries

ARTISTIC USE OF MASONRY



PRIVATE RESIDENCE

Designer: Scorpio Stone

Designer: Scorpio Stone

Masonry Contractor: Scorpio Masonry

Masonry Supplier: Scorpio Stone

ARTISTIC USE OF MASONRY



PURIFCATI MASONRY HEATER

Owner: Joe Purifcati

Designer: Adorn Masonry

General Contractor: Marcon Construction

Masonry Contractor: Adorn Masonry

Masonry Supplier: Cast Supply

Masonry Supplier: White Cap Supply Canada

ARTISTIC USE OF MASONRY



RESIDENCES OF KING EDWARD

Owner: Rockwood Custom Homes

Designer: Jenkins Architecture

Cornice Shop Drawings: Cleveland Quarries

Engineer: R.C. Park Engineering

General Contractor: Rockwood Custom Homes

Masonry Contractor: LMent Stone Ltd.

Masonry Supplier: White Cap Supply Canada

ARTISTIC USE OF MASONRY



RIVER PARK RESIDENCE

Designer: Dda Architecture Ltd.

Engineer: MWC Consulting Structural Engineers Inc.

General Contractor: Alec Williams Construction

Masonry Contractor: Cornerstone Masonry

Masonry Supplier: White Cap Supply Canada

Masonry Supplier (Stone): Rocky Mountain Stone Supply

ARTISTIC USE OF MASONRY



ROXBORO RESIDENCE

Designer: Dda Architecture Ltd.

Engineer: GC Engineering Ltd. (House)

General Contractor: Triangle Enterprises Ltd.

Masonry Contractor: Stonehouse Masonry

Masonry Supplier: White Cap Supply Canada

Engineer Masonry: BBStek Design Ltd.

ARTISTIC USE OF MASONRY



ROYAL MAYFAIR GOLF CLUB NEW CLUBHOUSE

Designer: Hodgson Schilf Evans Architects Inc.

General Contractor: Delnor Construction

Masonry Contractor: K Hansen Masonry

Masonry Supplier: Cast Supply

ARTISTIC USE OF MASONRY



SALISBURY HOME

Designer: Chernoff Architect Inc

General Contractor: William Blake Homes

Masonry Contractor: Tanners Masonry

Masonry Supplier: I-XL Building Products

ARTISTIC USE OF MASONRY



SAVANNA MARKET

Designer: Ace Architecture

General Contractor: Bird

Masonry Contractor: Am-Can Masonry

Masonry Supplier: IXL Building Products

ARTISTIC USE OF MASONRY

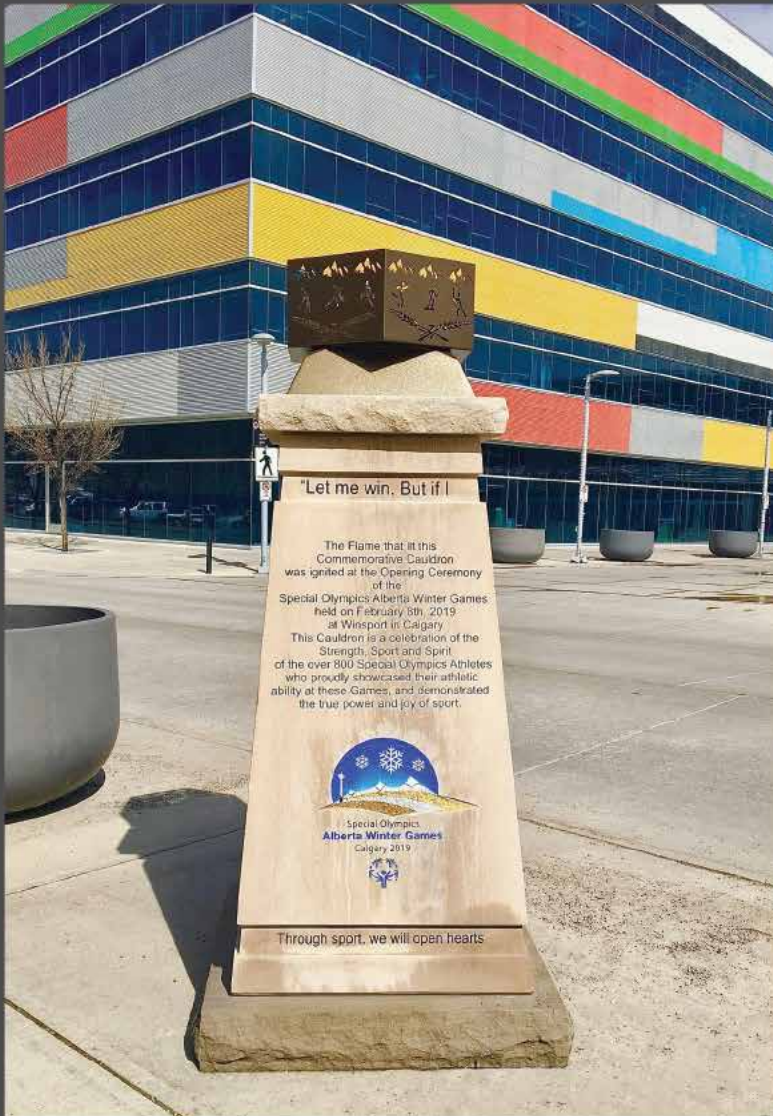

SPECIAL OLYMPICS MONUMENT CALGARY

Owner: Special Olympics Alberta

Masonry Contractor: Tanners Masonry

Masonry Supplier: Rocky Mountain Stone Supply

ARTISTIC USE OF MASONRY



ST. AUGUSTINE'S ANGLICAN CHURCH ADDITION

Owner: Anglican Diocese of Calgary

Designer: SONGER architecture inc

Engineer: MPE Engineering

General Contractor: RBG Construction

Masonry Contractor: Zrim Masonry

Masonry Supplier: White Cap Supply Canada

ARTISTIC USE OF MASONRY



STEIN RESIDENCE

Designer: Baywest Homes

General Contractor: Baywest Homes

Masonry Contractor: Am-Can Masonry

Masonry Supplier: IXL Building Products

Masonry Supplier: Rocky Mountain Stone Supply

ARTISTIC USE OF MASONRY



56 STONEWOOD DALE

General Contractor: Grandscape Homes

Masonry Contractor: Tanners Masonry

ARTISTIC USE OF MASONRY



THEBARN

Owner: Tanners Holdings Inc

Masonry Contractor: Tanners Masonry

Masonry Supplier: Rocky Mountain Stone Supply

ARTISTIC USE OF MASONRY



TYNDALL FIREPLACE

Designer: RUFproject

General Contractor: Plaid Shirt Project

Masonry Contractor: Am-Can Masonry

Masonry Supplier: White Cap Supply Canada

ARTISTIC USE OF MASONRY



UNIVERSITY OF ALBERTA - FLAG POLES

Owner: University of Alberta

Designer: GEC Architecture

Engineer: SMP Engineering

General Contractor: Clark Builders

Masonry Contractor: Scorpio Masonry

Masonry Supplier: Scorpio Stone

ARTISTIC USE OF MASONRY



44 UPLANDS WAY

General Contractor: Braemyn Homes

Masonry Contractor: Tanners Masonry

Masonry Supplier: Aspen Brick & Stone

ARTISTIC USE OF MASONRY



WESTMOUNT SCHOOL GROTESQUE REPAIR AND RESTORATION

Owner: Edmonton Public School Board

Designer: Boreas Architecture & Civic Design, Inc.

Material Scientist: Boreas Architecture & Civic Design, Inc.

General Contractor: Scorpio Masonry

Stone Carver and Mason: Akira Inman



Congratulations to all nominees and winners from everyone at Echelon Masonry.



ECHELON[®]
MASONRY



GO VERTICAL

KING
KLINKER
THIN BRICK

I-XL - Vancouver
604-574-2288

I-XL - Calgary
403-243-6031

I-XL - Edmonton
708-465-4848

I-XL - Saskatoon
306-664-3388

I-XL - Winnipeg
204-284-1773

I-XL - Toronto
905-565-0886

www.kingklinker-america.com

www.ixlbuild.com

OBSIDIAN SHADOW
IMPERIAL SIZE

AWARD OF EXCELLENCE – PLATINUM

COMMERCIAL BUILDING



SPIDER SITE - CALGARY

Owner: Certus Developments

Designer: McKinley Burkhart

Designer: Nam Dang Mitchell Design

General Contractor: Meiga Development Corp.

Masonry Contractor: Jackson Masonry Ltd.

Masonry Supplier: White Cap Supply Canada

Masonry Supplier: Rocky Mountain Stone Supply

AWARD OF EXCELLENCE – GOLD

COMMERCIAL BUILDING



MANCHESTER SQUARE

Owner: 76 Group Co

General Contractor: Apex Contracting

Masonry Contractor: Scorpio Masonry

AWARD OF EXCELLENCE – SILVER

COMMERCIAL BUILDING



PEAKS HOTEL & SUITES

Owner: Banff Park Lodge

Designer: METAFOR

General Contractor: CANA Construction

Masonry Contractor: Oskar Construction

Masonry Supplier: Thunderstone Quarries

COMMERCIAL BUILDING



AUGUST @ UNIVERSITY DISTRICT

Owner: August Limited Partnership

Designer: Lemay Michaud

Designer: AV Architecture

Engineer: Williams Engineering

General Contractor: Homes By Avi

Masonry Contractor: Aurora Masonry Ltd.

Masonry Supplier: I-XL Building Products

COMMERCIAL BUILDING



BLVD BELTLINE

Owner: ONE Properties

Designer: Arquitectonica

Designer: DIALOG

General Contractor: Axiom Builders

Masonry Contractor: Ib Jensen Masonry Ltd

Masonry Supplier: I-XL Building Products

Masonry Supplier: Cast Supply

COMMERCIAL BUILDING



CALGARY AIRPORT CASINO

Owner: Calgary Casino Ltd Partnership

Designer: Hodgson Schilf Evans Architects Inc.

General Contractor: Chandos Construction Ltd.

Masonry Contractor: Tanners Masonry

Masonry Supplier: Rocky Mountain Stone Supply

COMMERCIAL BUILDING



CARRINGTON GREEN

Owner: Royop

Designer: Systemic Architecture Inc.

General Contractor: Ledcor Group

Masonry Contractor: Tanners Holdings

Masonry Supplier: Timberstone Distribution

COMMERCIAL BUILDING



CHRISTIE CROSSING

Owner: Dominion

Designer: S2 Architecture

General Contractor: Bird Stuart Olsen Construction

Masonry Contractor: Bearstone Ex Masonry

Masonry Supplier: I-XL Building Products

COMMERCIAL BUILDING



COCHRANE PROTECTIVE SERVICES

Designer: ACI Architecture

General Contractor: Ellis Don

Masonry Contractor: Gordion Construction

Masonry Supplier: I-XL Building Products

COMMERCIAL BUILDING



4311 COMMERCIAL CENTRE

Owner: 1846614 Alberta Ltd.

Designer: Berry Architecture + Associates

Engineer: ONEC Group

General Contractor: Shunda Consulting & Construction Management Ltd.

Masonry Contractor: J.R. Masonry Western Ltd.

Masonry Supplier: IXL Building Products

Block Supplier: Expocrete

COMMERCIAL BUILDING



THE EDWARD

Designer: Section23 Developments

Engineer: Williams Engineering

Masonry Contractor: Ib Jensen Masonry Ltd

Masonry Supplier: I-XL Building Products

Masonry Supplier: Expocrete

COMMERCIAL BUILDING



FOUNDATION RESTORATION ST. PATRICK CHURCH

General Contractor: Father Stan St. Patrick's Church

Masonry Contractor: Gordon White

Masonry Supplier: Gordon White Sandstone

Consultant: Fireweed Consulting

COMMERCIAL BUILDING



GIBBARD BLOCK REHABILITATION

Owner: Sparrow Capital

Designer: Next Architecture Inc.

Engineer: Entuitive

General Contractor: Ledcor Construction

Masonry Contractor: Scorpio Masonry

Masonry Supplier: I-XL Building Products

Photographer: Brock Kryton Photography

COMMERCIAL BUILDING



THE GLENCOE GOLF & COUNTRY CLUB

General Contractor: Stuart Olson

Masonry Contractor: Tanners Masonry

Masonry Supplier: ThunderStone Quarries

COMMERCIAL BUILDING



HSBC BANK BUILDING

Owner: Epic Investments

Designer: Dialog

General Contractor: PCL Construction Management Inc.

Masonry Contractor: Scorpio Masonry

Masonry Supplier: Scorpio Stone

COMMERCIAL BUILDING



LAMPHOUSE BY BASECAMP

Owner: Basecamp Developments

Designer: Systemic Architecture Inc.

General Contractor: Basecamp/Shape Construction

COMMERCIAL BUILDING



LIVINGSTON HUB (FIRESTATION 44)

Owner: Brookfield Residential

Designer: S2 Architecture

General Contractor: Ledcor Construction

Masonry Contractor: All Exterior Designs

Masonry Supplier: I-XL Building Products

COMMERCIAL BUILDING



THE MALCOLM HOTEL

Owner: Spring Creek Mountain Village

Designer: METAFOR

General Contractor: Spring Creek Mountain Village

Masonry Contractor: Oskar Construction

Masonry Supplier: Thunderstone Quarries

COMMERCIAL BUILDING



MARTEL BLOCK

Designer: Systemic Architecture Inc.

General Contractor: CANA Construction

Masonry Contractor: Tanners Masonry

Masonry Supplier: Cast Supply

COMMERCIAL BUILDING



MEADOWS MILE PROFESSIONAL BUILDING

Owner: D&P Commercial Group

Designer: Spectrum Architecture

Masonry Contractor: Titan Masonry

Masonry Supplier: I-XL Building Products

COMMERCIAL BUILDING



OKOTOKS ARTS & LEARNING CENTRE

Designer: Diamond Schmitt Architects

General Contractor: Clark Builders

Masonry Contractor: Bearstone Ex Masonry

Masonry Supplier: I-XL Building Products

COMMERCIAL BUILDING



THE OLIVER (EAST TOWER)

Designer: GGA-Architecture

General Contractor: Centron Group

Masonry Contractor: Ib Jensen Masonry Ltd

Masonry Supplier: I-XL Building Products

COMMERCIAL BUILDING



ONE NORTH BUSINESS CENTRE

Owner: Lupi Homes

General Contractor: Bird Construction

Masonry Contractor: Tanners Masonry

Masonry Supplier: IXL Building Products

COMMERCIAL BUILDING



ROSE DIAMOND AT STANLEY PARK

Designer: Stantec Architecture Ltd.

Masonry Contractor: Tevmar Masory

Masonry Supplier: White Cap Supply Canada

COMMERCIAL BUILDING



ROYAL MAYFAIR GOLF CLUB NEW CLUBHOUSE

Designer: Hodgson Schilf Evans Architects Inc.

General Contractor: Delnor Construction

Masonry Contractor: K Hansen Masonry

Masonry Supplier: Cast Supply

COMMERCIAL BUILDING



SAVANNA MARKET

Designer: Ace Architecture

General Contractor: Bird

Masonry Contractor: Am-Can Masonry

Masonry Supplier: IXL Building Products

COMMERCIAL BUILDING



SETON CROSSING

General Contractor: Partners Developments

Masonry Contractor: Tanners Masonry

Masonry Supplier: TimberStone Distribution

COMMERCIAL BUILDING



SORAYA HAFEZ SCHOOL

Designer: ACI Architecture

General Contractor: Delnor Construction

Masonry Contractor: Scorpio Masonry

Masonry Supplier: I-XL Building Products

COMMERCIAL BUILDING



SOUTHPARK ON WHYTE

Owner: One Properties

Designer: Stantec Group Ltd

General Contractor: Ledcor Group

Masonry Contractor: Bearstone Ex Masonry

Masonry Supplier: I-XL Building Products

COMMERCIAL BUILDING



STETTLER HOSPITAL KITCHEN ADDITION

Owner: Alberta Health Services

Designer: McKay Hlavacek Architects

General Contractor: Westcor Construction

Masonry Contractor: J.R. Masonry Western Ltd.

Masonry Supplier: Timberstone Distribution

Accessories Supplier: White Cap Supply Canada

COMMERCIAL BUILDING



THE TAMARACK LODGE

Owner: Spring Creek Mountain Village

Designer: Hindle Architects

Engineer: TRL & Associates

General Contractor: Spring Creek Mountain Village

Masonry Contractor: Oskar Construction

Masonry Supplier: Thunderstone Quarries

Team Member: M Tech Designs

COMMERCIAL BUILDING



THELMA CHALIFOUX SCHOOL

Designer: ACI Architecture

General Contractor: Delnor Construction

Masonry Contractor: Scorpio Masonry

Masonry Supplier: I-XL Building Products

COMMERCIAL BUILDING



WILLIAM WATSON LODGE REDEVELOPMENT

Owner: Alberta Parks

Designer: METAFOR

General Contractor: Scott Builders Inc.

“WE ARE WHAT WE REPEATEDLY DO.
EXCELLENCE THEN, IS NOT AN ACT,
BUT A HABIT.” — Will Durant

Congratulations to the winners of
the **2024 Alberta Masonry Design Awards**.
Your imagination and creativity brings excellence
to the Alberta masonry community.



SPEC MIX-ALBERTA
Colin Thompson (403)-966-4041
WWW.SPECMIX.COM

© 2024 SPEC MIX

SPEC MIX®



RESIDENTIAL • COMMERCIAL
INSTITUTIONAL • RESTORATION

Restoring the past.
Building the future.



Am-Can Masonry Inc.
403-258-0180
sgilks@amcanmasonry.ca

Proud member of:
Masonry Contractor's Association of Alberta
Alberta Masonry Council



AWARD OF EXCELLENCE – PLATINUM

EDUCATIONAL / INSTITUTIONAL



HIGHLANDS SCHOOL EXPANSION AND MODERNIZATION

Owner: Edmonton Public Schools

Designer: ACI Architecture

Engineer: RJC Engineering

General Contractor: Bird Construction

Masonry Contractor: Northcan Construction Ltd

Masonry Supplier: Cast Supply

Masonry Supplier: Expocrete

AWARD OF EXCELLENCE – GOLD

EDUCATIONAL / INSTITUTIONAL



GENE ZWOZDESKY CENTRE AT NORWOOD

Owner: Alberta Health Services

Designer: Dialog

General Contractor: Clark Builders

Masonry Contractor: Scorpio Masonry

Masonry Supplier: Cast Supply

AWARD OF EXCELLENCE – SILVER

EDUCATIONAL / INSTITUTIONAL



OKOTOKS ARTS & LEARNING CENTRE

Designer: Diamond Schmitt Architects

General Contractor: Clark Builders

Masonry Contractor: Bearstone Ex Masonry

Masonry Supplier: I-XL Building Products

EDUCATIONAL / INSTITUTIONAL



AUBURN BAY SCHOOL

Owner: Calgary Board of Education

Designer: S2 Architecture

Engineer: TRL & Associates

General Contractor: CANA Group of Companies

Masonry Contractor: Gunthers Masonry

Masonry Supplier: Expocrete

EDUCATIONAL / INSTITUTIONAL

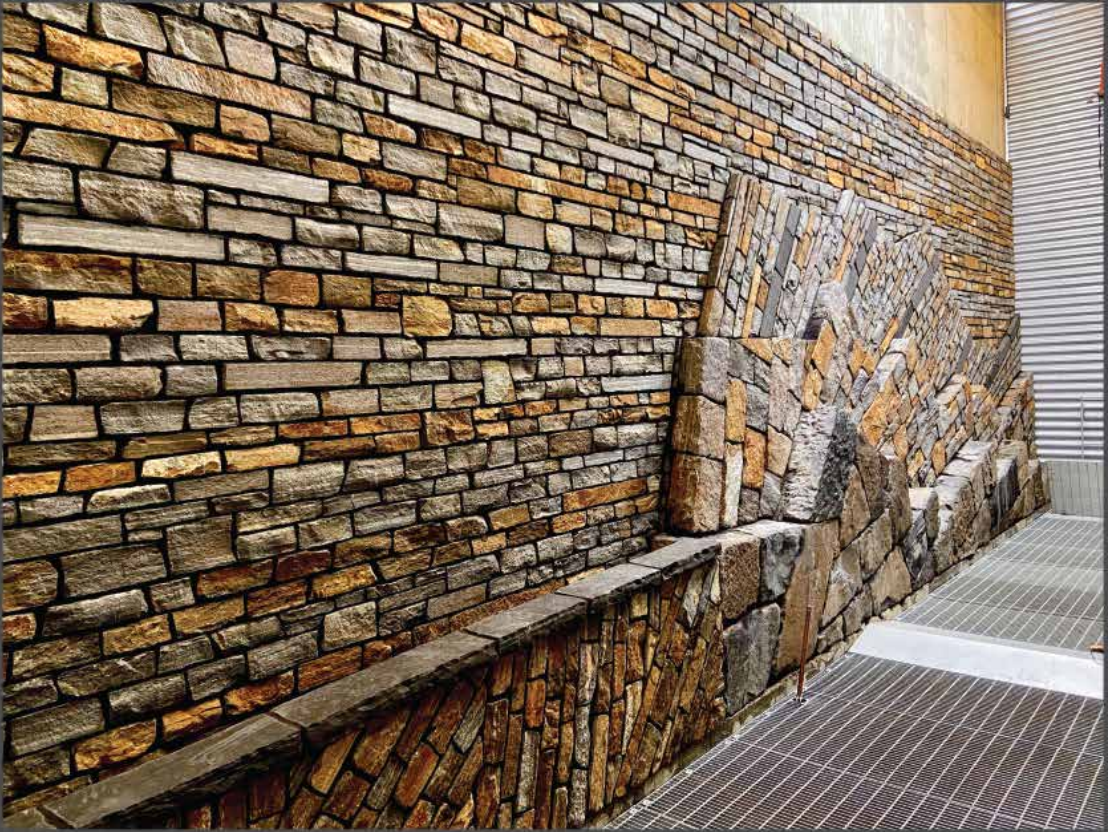

CALGARY CANCER CENTRE - LIGHT WELLS

Owner: Alberta Health Services

Designer: Dialog

Engineer: Stantec Consulting

General Contractor: PCL Construction Management Inc.

Masonry Contractor: Ib Jensen Masonry Ltd

Masonry Supplier: White Cap Supply Canada

EDUCATIONAL / INSTITUTIONAL



COCHRANE PROTECTIVE SERVICES

Designer: ACI Architecture

General Contractor: Ellis Don

Masonry Contractor: Gordion Construction

Masonry Supplier: I-XL Building Products

EDUCATIONAL / INSTITUTIONAL



CSSD HOLY TRINITY SCHOOL MODERNIZATION

Owner: Calgary Roman Catholic Separate School Division

Designer: Iwanski Architecture Inc.

Project Manager: Iwanski Architecture Inc.

Engineer: BEI Engineering 2000 Inc.

General Contractor: Dawson Wallace Construction Ltd.

Masonry Contractor: Bodner Masonry Construction Ltd.

Masonry Supplier: IXL Building Products

EDUCATIONAL / INSTITUTIONAL



DELIA K-12 REPLACEMENT SCHOOL

Owner: Prairie Land Regional Division #25

Designer: Iwanski Architecture Inc.

Engineer: BEI Engineering 2000 Inc.

General Contractor: Shunda Consulting & Construction Management Ltd.

Masonry Contractor: Block Tech Industries

Masonry Supplier: Cast Supply

EDUCATIONAL / INSTITUTIONAL



DENTISTRY PHARMACY BUILDING - UNIVERSITY OF ALBERTA

Owner: University of Alberta

Designer: GEC Architecture

General Contractor: Clark Builders

Masonry Contractor: Scorpio Masonry

Masonry Supplier: Timberstone Distribution

EDUCATIONAL / INSTITUTIONAL



DR. ANNE ANDERSON HIGH SCHOOL

Owner: Edmonton Public School Board

Designer: BR2 Architecture

General Contractor: Clark Builders

Masonry Contractor: K Hansen Masonry

Masonry Supplier: Expocrete

EDUCATIONAL / INSTITUTIONAL



ECOLE PERE KENNETH KEARNS SCHOOL ADDITION AND MODERNIZATION

Owner: Elk Island Catholic Separate Regional School Division No. 41

Designer: ONPA Architects

Engineer: BPTEC Engineering Ltd.

General Contractor: Jen-Col Construction

Masonry Contractor: J.R. Masonry Western Ltd.

Masonry Supplier: IXL Building Products

EDUCATIONAL / INSTITUTIONAL



EDMONTON CITY HALL PLAZA AND FOUNTAIN

Owner: City of Edmonton

Designer: GEC Architecture

Landscape Architect: Janet Rosenberg & Studio

Engineer: Arrow Engineering

General Contractor: Stanley Construction

Masonry Contractor: Scorpio Masonry

Masonry Supplier: A. Lacroix Granit

EDUCATIONAL / INSTITUTIONAL



FATHER LACOMBE SCHOOL REPLACEMENT

Owner: St. Thomas Aquinas Roman Catholic School Division

Designer: Group2 Architecture Interior Design Ltd.

Engineer: Williams Engineering

General Contractor: Shunda Consulting & Construction Management Ltd.

Masonry Contractor: J.R. Masonry Western Ltd.

Masonry Supplier: Cast Supply

Block Supplier: Expocrete

EDUCATIONAL / INSTITUTIONAL



FIRESIDE SCHOOL

Owner: Rockyview School Division

Designer: BR2 Architecture

General Contractor: Lear Construction

Masonry Contractor: Bearstone Ex Masonry

Masonry Supplier: Expocrete

EDUCATIONAL / INSTITUTIONAL



GENEVIEVE E. YATES MEMORIAL CENTRE RENEWAL

Owner: City of Lethbridge

Designer: SONGER architecture inc

Engineer: Entuitive

General Contractor: Stuart Olson

Masonry Contractor: Zrim Masonry

Masonry Supplier: White Cap Supply Canada

EDUCATIONAL / INSTITUTIONAL



GLENRIDDING STONE BLEND

Owner: Windermere Communities Inc.

Designer: IBI Group

Masonry Contractor: Scorpio Masonry

Masonry Supplier: Aspen Brick & Stone

EDUCATIONAL / INSTITUTIONAL



GOVERNMENT OF CANADA BUILDING, COALDALE

Owner: Government of Canada (RCMP)

Designer: ACI Architecture

Engineer: BPTEC Engineering Ltd.

General Contractor: Pomerleau Inc.

Masonry Contractor: Titan Masonry Ltd.

Masonry Supplier: White Cap Supply Canada

Masonry Supplier: Expocrete

EDUCATIONAL / INSTITUTIONAL



GRAND PRAIRIE COMPOSITE HIGH SCHOOL REPLACEMENT

Owner: Grande Prairie School Division
Designer: The Workun Garrick Partnership
Architecture and Interior Design Inc.
Engineer: SPA Engineering
General Contractor: Aman Builders Inc
Masonry Contractor: K Hansen Masonry
Masonry Supplier: White Cap Supply Canada
Masonry Supplier: Expocrete

EDUCATIONAL / INSTITUTIONAL



HOLY SPIRIT SCHOOL

Owner: Catholic School Board

Designer: S2 Architecture

Engineer: TRL & Associates

General Contractor: CANA Group of Companies

Masonry Contractor: Bearstone Ex Masonry

Masonry Supplier: Expocrete

EDUCATIONAL / INSTITUTIONAL



JAGARE RIDGE - DEVELOPMENT AND WATERFALL FEATURES

Owner: Melcor Developments

Designer: IBI Group

Lighting: DES Engineering

Engineer: IBI Group

General Contractor: Melcor Developments

Masonry Contractor: Bombini Masonry

Masonry Supplier: Aspen Brick & Stone

EDUCATIONAL / INSTITUTIONAL



LIVINGSTON HUB (FIRESTATION 44)

Owner: Brookfield Residential

Designer: S2 Architecture

General Contractor: Ledcor Construction

Masonry Contractor: All Exterior Designs

Masonry Supplier: I-XL Building Products

EDUCATIONAL / INSTITUTIONAL



MANYHORSES HIGH SCHOOL

Owner: Tsuut'ina Nation

**Designer: The Workun Garrick Partnership
Architecture and Interior Design Inc.**

Engineer: Protostatix

General Contractor: Bird Construction

Masonry Contractor: Bearstone Ex Masonry

Masonry Supplier: Cast Supply

EDUCATIONAL / INSTITUTIONAL

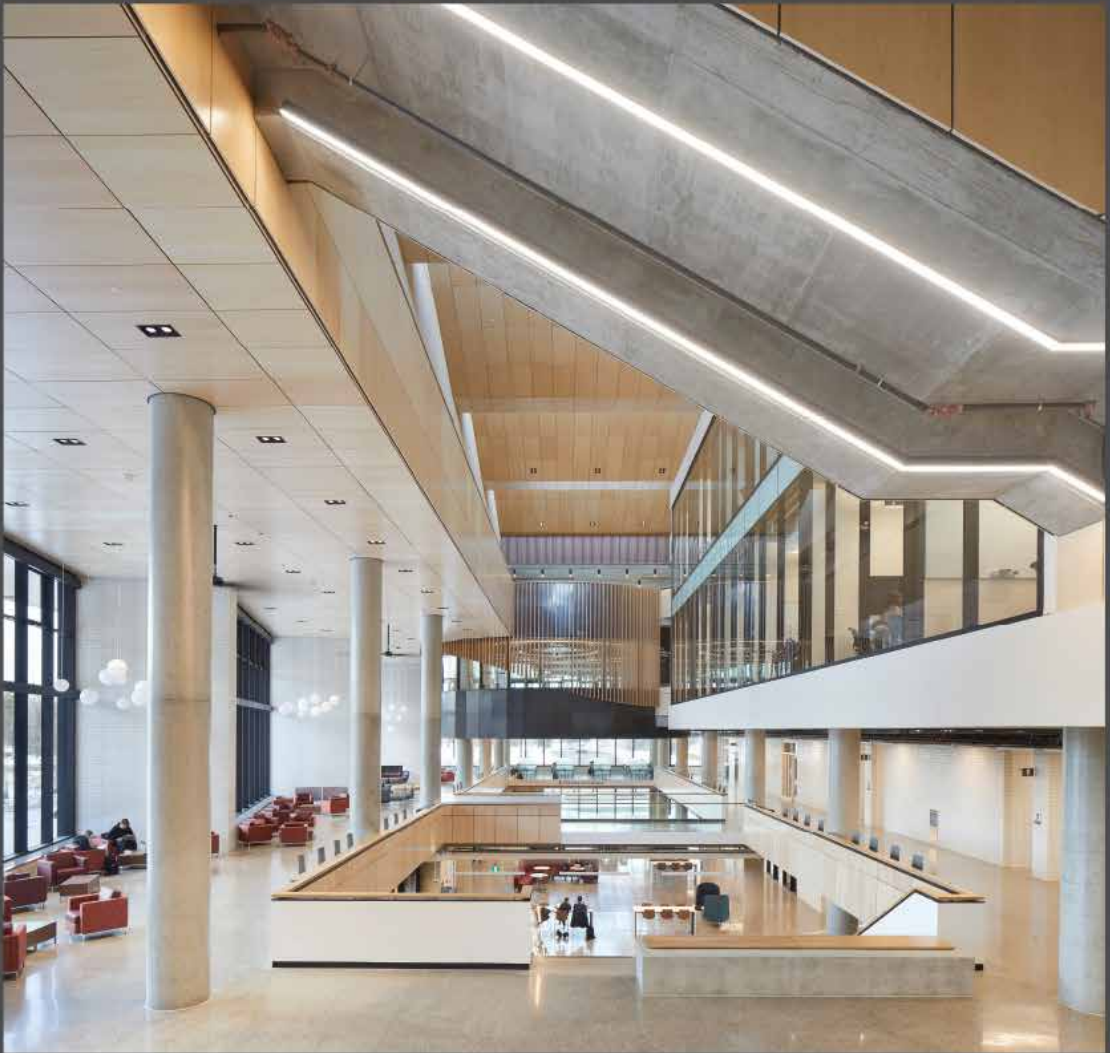

MATHISON HALL

Owner: University of Calgary

Designer: GGA-Architecture

Engineer: Entuitive

General Contractor: EllisDon

Masonry Contractor: Ib Jensen Masonry Ltd

Masonry Supplier: White Cap Supply Canada

EDUCATIONAL / INSTITUTIONAL



MONTGOMERY HIGH SCHOOL REPLACEMENT

Owner: Alberta Infrastructure

Designer: GGA - Architecture

Engineer: TRL & Associates

General Contractor: Lear Construction

Masonry Contractor: BCL Brothers Masonry Contracting

Masonry Supplier: I-XL Building Products

Masonry Supplier: White Cap Supply Canada

EDUCATIONAL / INSTITUTIONAL



ROSE DIAMOND AT STANLEY PARK

Designer: Stantec Architecture Ltd.

Masonry Contractor: Tevmar Masory

Masonry Supplier: White Cap Supply Canada

EDUCATIONAL / INSTITUTIONAL



SHRINE CHURCH OF OUR LADY OF THE ROCKIES

Owner: Roman Catholic Diocese of Calgary

Designer: Boruk Ron Architect

Architect: NORR

Engineer: NORR

General Contractor: Modco Structures

Masonry Contractor: Oskar Construction

Masonry Supplier: Rundle Rock Building Stone

EDUCATIONAL / INSTITUTIONAL



SIBYLLA KIDDLE SCHOOL

Owner: Calgary Board of Education

Designer: GGA Architecture

Engineer: Entuitive

Masonry Contractor: Gunthers Masonry

Masonry Supplier: Expocrete

Masonry Supplier: I-XL Building Products

EDUCATIONAL / INSTITUTIONAL



SORAYA HAFEZ SCHOOL

Designer: ACI Architecture

General Contractor: Delnor Construction

Masonry Contractor: Scorpio Masonry

Masonry Supplier: I-XL Building Products

EDUCATIONAL / INSTITUTIONAL



ST. AUGUSTINE'S ANGLICAN CHURCH ADDITION

Owner: Anglican Diocese of Calgary

Designer: SONGER architecture inc

Engineer: MPE Engineering

General Contractor: RBG Construction

Masonry Contractor: Zrim Masonry

Masonry Supplier: White Cap Supply Canada

EDUCATIONAL / INSTITUTIONAL



ST. LORENZO RUIZ MIDDLE SCHOOL

Owner: Red Deer Catholic Regional Schools

Designer: Group2 Architecture Interior Design Ltd.

General Contractor: Clark Builders

Masonry Contractor: J.R. Masonry Western Ltd.

Masonry Supplier: Expocrete

EDUCATIONAL / INSTITUTIONAL



SUNALTA SCHOOL

Owner: Calgary Board of Education

Designer: RJC Engineers

Engineer: RJC Engineers

General Contractor: SynCon Management

Masonry Contractor: Am-Can Masonry

EDUCATIONAL / INSTITUTIONAL



THELMA CHALIFOUX SCHOOL

Designer: ACI Architecture

General Contractor: Delnor Construction

Masonry Contractor: Scorpio Masonry

Masonry Supplier: I-XL Building Products

PROUD

supporters of the
Alberta Masonry
Council and the 2024
Alberta Masonry
Design Awards



TANNERS MASONRY
 *More than Masons*

Experience The
Tanners Advantage.
Where craftsmanship
meets excellence!



CONTACT US TODAY!

🌐 www.ferocorp.com ☎ 1-877-703-4463
✉ engineering@ferocorp.com

THERMAL TIE™ MASONRY CONNECTORS + **FAST THERMAL BRACKET™ OFFSET SHELF ANGLE SUPPORT**



- ✓ Verified best-in-class thermal performance
- ✓ Ideal engineered solution for all cavity sizes
- ✓ Cost-effective, easy installation and on-site adjustability
- ✓ Delegated design and engineering

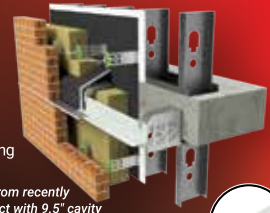

Wall assembly from recently completed project with 9.5" cavity



FERO Thermal Tie™ Masonry Connectors

- ▶ Industry-leading structural and thermal performance without unnecessary and expensive composite materials
- ▶ High-strength ties allow for increased spacing, larger cavity widths, reduced penetrations and lower costs



FAST Thermal Bracket™ Offset Shelf Angle Support

- ▶ Offset shelf angle from back-up wall with manufactured structural thermal breaks providing near continuous insulation and **improving thermal performance by 84% compared to conventional shelf angle**
- ▶ Significantly reduce shelf angle costs and make installation easy with smaller and lighter shelf angle

Copyright © 2024 FERO Corporation
FERO®, FERO Thermal Tie™, Rap-Tie® Stud Shear®, FERO V-Tie™, L-Plate®, FAST®, Thermal Bracket™, FAST-FLEX™ are registered trademarks of FERO Corporation. The FERO family of Masonry Wall Connectors, as installed, may fall within the scope of one or more issued patents or pending patent applications, according to the applicable installation type. Those patents include US 8,051,621; US 8,555,595; US 8,893,452 and corresponding Canadian Patents CA 2,566,552; CA 2,700,636; and CA 2,804,542. The FERO FAST family of masonry supports, as installed may fall within the scope of one or more US or foreign patents or patent applications. Those patents include US 9,316,004; US 9,447,585; US 10,323,419; US 10,294,676; 11,041,315; and other pending applications. Other US and Foreign Patents Pending.

Masonry Contractors Association of Alberta

Proud sponsor of the 2024 Alberta Masonry Design Awards

Specialists in Masonry Construction

Our skilled contractor members bring your vision to life with precision and craftsmanship.



MCAA is proud to be part of the greater community with our 4 pillars:

- Post secondary involvement through research and scholarships
- Apprenticeship support from our Contractor members
- National Programming support of CSA Standards and the Masonry Design Centre
- Contractor Support through learning and governance



www.mca-canada.com

AWARD OF EXCELLENCE – PLATINUM

MULTI FAMILY RESIDENTIAL



LONDONDERRY MIXED-MARKET HOUSING

Owner: Civida

Designer: GEC Architecture

Engineer: RJC Engineers

General Contractor: Stuart Olson

Masonry Contractor: Scorpio Masonry

Masonry Supplier: I-XL Building Products

Masonry Supplier: White Cap Supply Canada

AWARD OF EXCELLENCE – GOLD

MULTI FAMILY RESIDENTIAL



MCKENZIE MEWS

Owner: Cube Development Ltd.

Designer: Block Group Ltd.

Engineer: PH McNally and Associates Ltd.

General Contractor: BR Construction Inc.

Masonry Contractor: Mayzes Masonry Inc.

Masonry Supplier: I-XL Building Products

AWARD OF EXCELLENCE – SILVER

MULTI FAMILY RESIDENTIAL



RESIDENCES OF KING EDWARD

Owner: Rockwood Custom Homes

Designer: Jenkins Architecture

Cornice Shop Drawings: Cleveland Quarries

Engineer: R.C. Park Engineering

General Contractor: Rockwood Custom Homes

Masonry Contractor: LMent Stone Ltd.

Masonry Supplier: White Cap Supply Canada

MULTI FAMILY RESIDENTIAL



THE APOLLO AT GREENWICH

Designer: S2 Architecture

General Contractor: Cove Properties

Masonry Contractor: Jackson Masonry Ltd.

Masonry Supplier: I-XL Building Products

MULTI FAMILY RESIDENTIAL



AUGUST @ UNIVERSITY DISTRICT

Owner: August Limited Partnership

Designer: Lemay Michaud

Designer: AV Architecture

Engineer: Williams Engineering

General Contractor: Homes By Avi

Masonry Contractor: Aurora Masonry Ltd.

Masonry Supplier: I-XL Building Products

MULTI FAMILY RESIDENTIAL



BLVD BELTLINE

Owner: ONE Properties

Designer: Arquitectonica

Designer: DIALOG

General Contractor: Axiom Builders

Masonry Contractor: Ib Jensen Masonry Ltd

Masonry Supplier: I-XL Building Products

Masonry Supplier: Cast Supply

MULTI FAMILY RESIDENTIAL



BRIDGE

Owner: JEMM Properties

Designer: Zeidler Architecture

General Contractor: ITC Construction

Masonry Contractor: Ib Jensen Masonry Ltd

Masonry Supplier: I-XL Building Products

MULTI FAMILY RESIDENTIAL



BRIDLEWOOD AFFORDABLE HOUSING

Owner: City of Calgary

Designer: METAFOR

General Contractor: Graham Construction

Masonry Contractor: Am-Can Masonry

Masonry Supplier: Cast Supply

MULTI FAMILY RESIDENTIAL



CAPELLA CONDOS

Designer: Mckinley Studios

Engineer: MMP Engineering

General Contractor: Brookfield Residential

Masonry Contractor: Am-Can Masonry

Masonry Supplier: White Cap Supply Canada

MULTI FAMILY RESIDENTIAL



THE CLIFTON

Owner: ONE Properties

Designer: Dialog

General Contractor: Clark Builders

Masonry Contractor: Scorpio Masonry

Masonry Supplier: Cast Supply / Expocrete / Scorpio Stone

MULTI FAMILY RESIDENTIAL



THE EDWARD

Designer: Section23 Developments

Engineer: Williams Engineering

Masonry Contractor: Ib Jensen Masonry Ltd

Masonry Supplier: I-XL Building Products

Masonry Supplier: Expocrete

MULTI FAMILY RESIDENTIAL



ELVEDEN COURT

Designer: Paul Lavoie Interior Design

General Contractor: Moderno

Masonry Supplier: I-XL Building Products

MULTI FAMILY RESIDENTIAL



ERA

Owner: Minto

Designer: Casola Koppe Architects

Engineer: Entuitive

General Contractor: PCL

Masonry Contractor: Am-Can Masonry

Masonry Supplier: White Cap Supply Canada

Masonry Supplier: Expocrete

MULTI FAMILY RESIDENTIAL



THE IVY

Designer: Stantec Architecture Ltd.

General Contractor: Brookfield Residential

Masonry Contractor: Am-Can Masonry

Masonry Supplier: I-XL Building Products

MULTI FAMILY RESIDENTIAL



KINGSMITH BUILDERS WILLOWS - COCHRANE

Owner: Kingsmith Builders

General Contractor: Kingsmith homes

Masonry Contractor: Nordic Stoneworks

Masonry Supplier: White Cap Supply Canada

Bricklayer: Oxford Masonry

MULTI FAMILY RESIDENTIAL



LENDRUM REDEVELOPMENT

Owner: CIVIDA

Designer: Rockliff Pierzchajlo Kroman (RPK) Architects

General Contractor: Graham Construction & Engineering LP

Masonry Contractor: Scorpio Masonry

Masonry Supplier: I-XL Building Products

MULTI FAMILY RESIDENTIAL



LOOKOUT RIDGE

Designer: METAFOR

General Contractor: Distinctive Homes

Masonry Contractor: Oskar Construction

Masonry Supplier: I-XL Building Products

MULTI FAMILY RESIDENTIAL



THE MACLAREN

Owner: Edgar Developments

Designer: Dialog

General Contractor: Clark Builders

Masonry Contractor: Scorpio Masonry

Masonry Supplier: I-XL Building Products

MULTI FAMILY RESIDENTIAL



MID TOWN - AVERTON

General Contractor: Averton

Masonry Contractor: Franks Masonry

Masonry Supplier: I-XL Building Products

Masonry: YEG masonry

MULTI FAMILY RESIDENTIAL



THE OLIVER (EAST TOWER)

Designer: GGA-Architecture

General Contractor: Centron Group

Masonry Contractor: Ib Jensen Masonry Ltd

Masonry Supplier: I-XL Building Products

MULTI FAMILY RESIDENTIAL



PIVOT - RUTHERFORD

General Contractor: Averton

Masonry Contractor: Franks Masonry

Masonry Supplier: I-XL Building Products

MULTI FAMILY RESIDENTIAL



RAYMOND BLOCK

Owner: Wexford Developments

Designer: Dialog

General Contractor: Clark Builders

Masonry Contractor: Scorpio Masonry

Masonry Supplier: Cast Supply / Expconcrete

Masonry Supplier: Scorpio Stone

MULTI FAMILY RESIDENTIAL



RESIDENCES 7TH AND 7TH

Owner: Distinctive Homes

Designer: METAFOR

General Contractor: Distinctive Homes

Masonry Contractor: Oskar Construction

Masonry Supplier: I-XL Building Products

MULTI FAMILY RESIDENTIAL



3824 17TH STREET SW- CALGARY

Designer: Inertia Residential Design

General Contractor: Willix Developments

Masonry Contractor: High Standard Installations

Masonry Supplier: I-XL Building Products

MULTI FAMILY RESIDENTIAL



SOUTHPARK ON WHYTE

Owner: One Properties

Designer: Stantec Group Ltd

General Contractor: Ledcor Group

Masonry Contractor: Bearstone Ex Masonry

Masonry Supplier: I-XL Building Products

MULTI FAMILY RESIDENTIAL



STADIUM YARDS

Owner: Rohit Properties

Masonry Contractor: Remo's Masonry

Masonry Supplier: I-XL Building Products

MULTI FAMILY RESIDENTIAL



STEPS BRIDGELAND

Owner: Centurion Apartment Properties

Designer: Sturgess Architecture

General Contractor: Scott Construction

Masonry Contractor: Ib Jensen Masonry Ltd

Masonry Supplier: I-XL Building Products

MULTI FAMILY RESIDENTIAL



THE VICTORIA ON FIFTH

Owner: Spray Group

Designer: Casola Koppe Architects

General Contractor: Spray Group

Masonry Contractor: Tanners Masonry

Masonry Supplier: White Cap Supply Canada

MULTI FAMILY RESIDENTIAL



THE VIEWS

Owner: Statesman Homes

General Contractor: Statesman Homes

Masonry Contractor: Am-Can Masonry

Masonry Supplier: I-XL Building Products

MULTI FAMILY RESIDENTIAL



WALKER LAKE APARTMENTS

Owner: Cameron Developments

Designer: Kennedy Create Architects

General Contractor: Krawford Construction Inc

Masonry Contractor: Remos Masonry

Masonry Supplier: I-XL Building Products



Giving peace-of-mind to masons & contractors for over 40 years. Basalite offers a wide range of high quality block, mortar, grout & accessories.

Basalite's Mortar-Tek™ is a pre-blended mortar that offers superior workability, consistent quality & helps increase overall productivity.

WWW.BASALITE.CA

233183 RANGE ROAD 283, CALGARY | 800-596-3844

Westlake

Royal Building Products™

STONE SOLUTIONS

Our portfolio of architectural stone veneer provides limitless design opportunities that suit a wide range of styles and budgets, enhancing your project's aesthetic using natural textures and authentic color palettes.



CULTURED
STONE™

ELDORADO
STONE™



DUTCH QUALITY STONE.™

ElevateWithStone.com

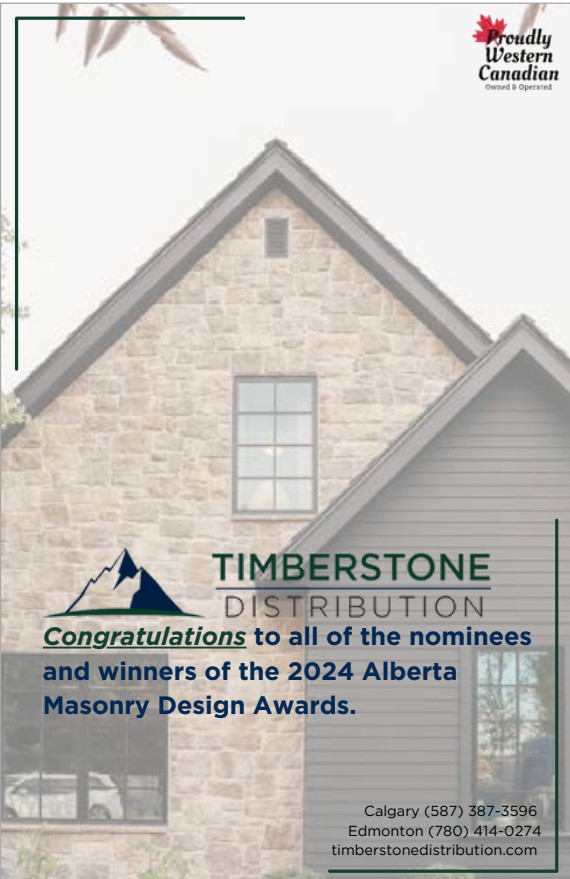

TIMBERSTONE
DISTRIBUTION

***Congratulations* to all of the nominees and winners of the 2024 Alberta Masonry Design Awards.**

Calgary (587) 387-3596
Edmonton (780) 414-0274
timberstonedistribution.com

Congratulations

TO ALL WINNERS
AND PARTICIPANTS

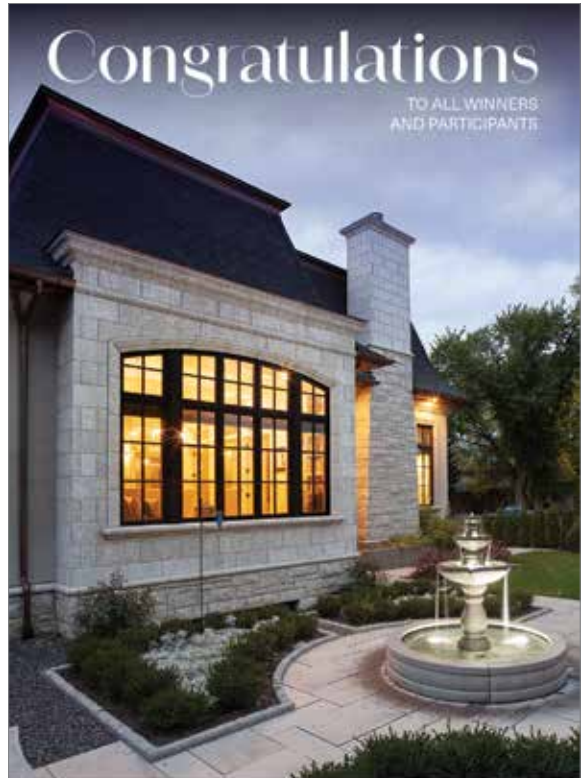

450 Million Years of History

Proud Sponsor of the
2024 Masonry Design Awards

GILLIS QUARRIES



AWARD OF EXCELLENCE – PLATINUM

RESTORATION



LEGISLATURE BUILDING STONE CLADDING AND WINDOW RESTORATION

Owner: Alberta Infrastructure
Engineer: Building Science Engineering
General Contractor: Scorpio Masonry
Masonry Contractor: Scorpio Masonry
Masonry Supplier: Scorpio Stone

AWARD OF EXCELLENCE – GOLD

RESTORATION



BOWKER BUILDING RESTORATION

Owner: Alberta Infrastructure
Engineer: Building Science Engineering
General Contractor: Scorpio Masonry
Masonry Contractor: Scorpio Masonry
Masonry Supplier: Scorpio Stone

AWARD OF EXCELLENCE – SILVER

RESTORATION



KEILLOR SUMMER KITCHEN

Owner: City of Edmonton

Designer: David Murray Architect

General Contractor: Delnor Construction

Masonry Contractor: Scorpio Masonry

Masonry Supplier: Cast Supply

RESTORATION



BREWERY BUILDING 11

Owner: First Capital Realty

Designer: Dialog

General Contractor: Chandos Construction Ltd.

Masonry Contractor: Scorpio Masonry

RESTORATION



CALGARY PUBLIC BUILDING REHABILITATION

Owner: City of Calgary

Designer: Lemay

Designer: EVOQ Architecture

Engineer: RJC Engineers

General Contractor: EllisDon

Masonry Contractor: Ib Jensen Masonry Ltd.

Masonry Supplier: Gillis Quarries

RESTORATION



DENTISTRY PHARMACY BUILDING - UNIVERSITY OF ALBERTA

Owner: University of Alberta

Designer: GEC Architecture

General Contractor: Clark Builders

Masonry Contractor: Scorpio Masonry

Masonry Supplier: Timberstone Distribution

RESTORATION



ELBOW PARK HERITAGE

Designer: Dda Architecture Ltd.

Engineer: KTA Structural Engineers Ltd.

General Contractor: Triangle Enterprises Ltd.

Masonry Contractor: Rocky Mountain Masonry

Masonry Supplier: Rocky Mountain Stone Supply

RESTORATION



FOUNDATION RESTORATION ST. PATRICK CHURCH

General Contractor: Father Stan St. Patrick's Church

Masonry Contractor: Gordon White

Masonry Supplier: Gordon White Sandstone

Consultant: Fireweed Consulting

RESTORATION



GIBBARD BLOCK REHABILITATION

Owner: Sparrow Capital

Designer: Next Architecture Inc.

Engineer: Entuitive

General Contractor: Ledcor Construction

Masonry Contractor: Scorpio Masonry

Masonry Supplier: I-XL Building Products

Photographer: Brock Kryton Photography

RESTORATION



INDUSTRIAL HEALTH LAB (HISTORIC LAND TITLES BUILDING)

Owner: Alberta Infrastructure

Designer: Group 2

General Contractor: Chandos Construction Ltd.

Masonry Contractor: Scorpio Masonry

Masonry Supplier: Cast Supply

RESTORATION



KEILLOR STONE HOUSE AND SUMMER KITCHEN RESTORATION

Owner: City of Edmonton

Designer: SPECTACLE

Historical Architect: David Murray Architect

Structural and Envelope Engineer: Entuitive

General Contractor: Delnor Construction

Masonry Contractor: Scorpio Masonry

Roofing Contractor: Belvedere Roofing

RESTORATION



LAMPHOUSE BY BASECAMP

Owner: Basecamp Developments

Designer: Systemic Architecture Inc.

General Contractor: Basecamp/Shape Construction

RESTORATION



MACDOUGALL CENTER

Owner: Alberta Infrastructure

Designer: RKH Architecture

General Contractor: Scorpio Masonry

Masonry Contractor: Scorpio Masonry

RESTORATION



PRIVATE RESIDENCE

Designer: Scorpio Stone

Designer: Scorpio Stone

Masonry Contractor: Scorpio Masonry

Masonry Supplier: Scorpio Stone

RESTORATION



PROSPECT HERITAGE HOME

Designer: Dda Architecture Ltd.

Engineer: Heninger Structural Engineering Ltd.

General Contractor: Waterford Homes Inc.

Masonry Contractor: Brxton Masonry

Masonry Supplier: White Cap Supply Canada

RESTORATION



REVILLON BOARDWALK EXTERIOR

Owner: Allied Properties REIT

Designer: Boreas Architecture & Civic Design, Inc.

General Contractor: Scorpio Masonry

Masonry Contractor: Scorpio Masonry

Masonry Supplier: Scorpio Stone

RESTORATION



SUNALTA SCHOOL

Owner: Calgary Board of Education

Designer: RJC Engineers

Engineer: RJC Engineers

General Contractor: SynCon Management

Masonry Contractor: Am-Can Masonry

RESTORATION



THE PENDENNIS

Owner: Mercy Consulting

General Contractor: Delnor Construction

Masonry Contractor: Scorpio Masonry

Masonry Supplier: Scorpio Stone

RESTORATION



WESTMOUNT SCHOOL GROTESQUE REPAIR AND RESTORATION

Owner: Edmonton Public School Board

Designer: Boreas Architecture & Civic Design, Inc.

Material Scientist: Boreas Architecture & Civic Design, Inc.

General Contractor: Scorpio Masonry

Stone Carver and Mason: Akira Inman



THUNDERSTONE
QUARRIES

RUNDLE STONE

Versatile
Simple Elegance
Nature's Way
Timeless

Congratulations to all
participants and winners of the
2024 Masonry Design Awards!

Quarry: 1.888.678.6234 / Sales Office: 403.257.2007
www.thunderstonequarry.com

Oskar Construction Ltd.

*Specializing in natural stone
masonry since 1994*



Peaks Hotel and Suites, Banff, Alberta

oskarconstruction.com

oskcon@gmail.com

Office: 403 762 3131

Fax : 403 762 3135

Cell: 403 678 1118

124 Eagle Crescent | Banff, Alberta T1L 1A8



IB JENSEN
MASONRY LTD

EST. 1956



CONTACT

3632 Manchester Rd S.E.,

Calgary, Alberta T2G-3Z5

403-243-6303

estimating@ibjensenmasonry.com

www.ibjensenmasonry.com

J.R. MASONRY WESTERN LTD.

jrmasonrywestern.com



3714 - 53 Avenue • Lacombe, AB T4L 0A9
403-348-0500 tom@jrmasonrywestern.com

AWARD OF EXCELLENCE – PLATINUM

SINGLE FAMILY RESIDENTIAL



BRITANNIA TYNDALL STONE CUSTOM HOME

Designer: Hallett Architects Ltd.

Stone and Exterior Fireplace Design: Corse Construction Inc.

Engineer: H.D. Richardson & Associates Ltd.

General Contractor: Corse Construction Inc.

Masonry Contractor: LMent Stone Ltd

Masonry Supplier: White Cap Supply Canada

AWARD OF EXCELLENCE – GOLD

SINGLE FAMILY RESIDENTIAL



SALISBURY HOME

Designer: Chernoff Architect Inc

General Contractor: William Blake Homes

Masonry Contractor: Tanners Masonry

Masonry Supplier: I-XL Building Products

AWARD OF EXCELLENCE – SILVER

SINGLE FAMILY RESIDENTIAL



BEL-AIRE RESIDENCE

Designer: Dda Architecture Ltd.

Engineer: ISL Engineering

General Contractor: Waterford Homes Inc.

Masonry Contractor: Stonehouse Masonry

Masonry Supplier: Rocky Mountain Stone Supply

SINGLE FAMILY RESIDENTIAL



THE ALPINE

Designer: Boss Design

General Contractor: Hampton Homes

Masonry Contractor: YEG Masonry

Masonry Supplier: White Cap Supply Canada

SINGLE FAMILY RESIDENTIAL



ALTADORE PROJECT

Designer: RUFproject

General Contractor: Plaid Shirt Ltd.

Masonry Contractor: Am-Can Masonry

Masonry Supplier: White Cap Supply Canada

SINGLE FAMILY RESIDENTIAL



BEL-AIRE CONTEMPORARY

Designer: Dda Architecture Ltd.

Engineer: ISL Engineering

General Contractor: Waterford Homes Inc.

Masonry Contractor: Stonehouse Masonry

Masonry Supplier: Cast Supply (Brick)

Stone Supplier: Rocky Mountain Stone Supply

SINGLE FAMILY RESIDENTIAL



BRITANNIA RESIDENCE

Designer: Dda Architecture Ltd.

Engineer: KTA Structural Engineers Ltd.

General Contractor: Triangle Enterprises Ltd.

Masonry Contractor: Tanners Masonry

Masonry Supplier: Rocky Mountain Stone Supply

SINGLE FAMILY RESIDENTIAL



CANADIAN BRICK INFILL

Designer: Heirloom Homes

General Contractor: Heirloom Homes

Masonry Contractor: DMG Masonry

Masonry Supplier: Aspen Brick & Stone

SINGLE FAMILY RESIDENTIAL



CATALOG HOME

General Contractor: Newground Developments

Masonry Contractor: BrickSmith Masonry

Masonry Supplier: I-XL Building Products

SINGLE FAMILY RESIDENTIAL



CHAN RESIDENCE

General Contractor: Mairén Homes

Masonry Contractor: Greystone Masonry

Masonry Supplier: I-XL Building Products

SINGLE FAMILY RESIDENTIAL



CITY VIEW - HILLTOP MANOR

Designer: Graphtec Design

General Contractor: Newground Developments

Masonry Contractor: Stone Skills Masonry

Masonry Supplier: Aspen Brick & Stone

SINGLE FAMILY RESIDENTIAL



544 CRESCENT ROAD NW

Masonry Contractor: Tanners Masonry

Masonry Supplier: White Cap Supply Canada

SINGLE FAMILY RESIDENTIAL



EDMONTON SKYLINE VIEW PROJECT

Designer: Boss Design

Interior Design: Kyle and Co Design

General Contractor: Alair Homes

Masonry Contractor: Elite Elevations Masonry

Masonry Supplier: Aspen Brick & Stone

SINGLE FAMILY RESIDENTIAL



ELBOW PARK HERITAGE

Designer: Dda Architecture Ltd.

Engineer: KTA Structural Engineers Ltd.

General Contractor: Triangle Enterprises Ltd.

Masonry Contractor: Rocky Mountain Masonry

Masonry Supplier: Rocky Mountain Stone Supply

SINGLE FAMILY RESIDENTIAL



2023 FHL AVERTON

General Contractor: Averton

Masonry Contractor: Franks Masonry

Masonry Supplier: I-XL Building Products

SINGLE FAMILY RESIDENTIAL



GEORGIAN REVIVAL HOUSE

Designer: Systemic Architecture Inc.

Interior Designer: Holland Design

Engineer: Ground3 Landscape Architect

General Contractor: Casman Group of Companies

Masonry Contractor: Tanners Masonry

Masonry Supplier: Aspen Brick & Stone

Historical Stone Supplier: Uniquities Architectural Antiques & Salvage

SINGLE FAMILY RESIDENTIAL



THE GRAND ARCHES

General Contractor: Grandscape Homes

Masonry Contractor: Tanners Masonry

Masonry Supplier: Rocky Mountain Stone Supply

SINGLE FAMILY RESIDENTIAL



HANSON RESIDENCE

Owner: Hanson

General Contractor: KBM Homes

Masonry Contractor: Adorn Masonry

Masonry Supplier: White Cap Supply Canada

SINGLE FAMILY RESIDENTIAL



830 HILLCREST AVE CALGARY

Designer: McDowell & Associates Inc.

General Contractor: Rawlyk Developments

Masonry Contractor: Tanners Masonry

Masonry Supplier: White Cap Supply Canada

Masonry Supplier: Rocky Mountain Stone Supply

SINGLE FAMILY RESIDENTIAL



HILLVIEW LOTTERY HOME

Designer: interiors by design inc

General Contractor: Hillview Master Builder

Masonry Contractor: Franks Masonry

Masonry Supplier: I-XL Building Products

SINGLE FAMILY RESIDENTIAL

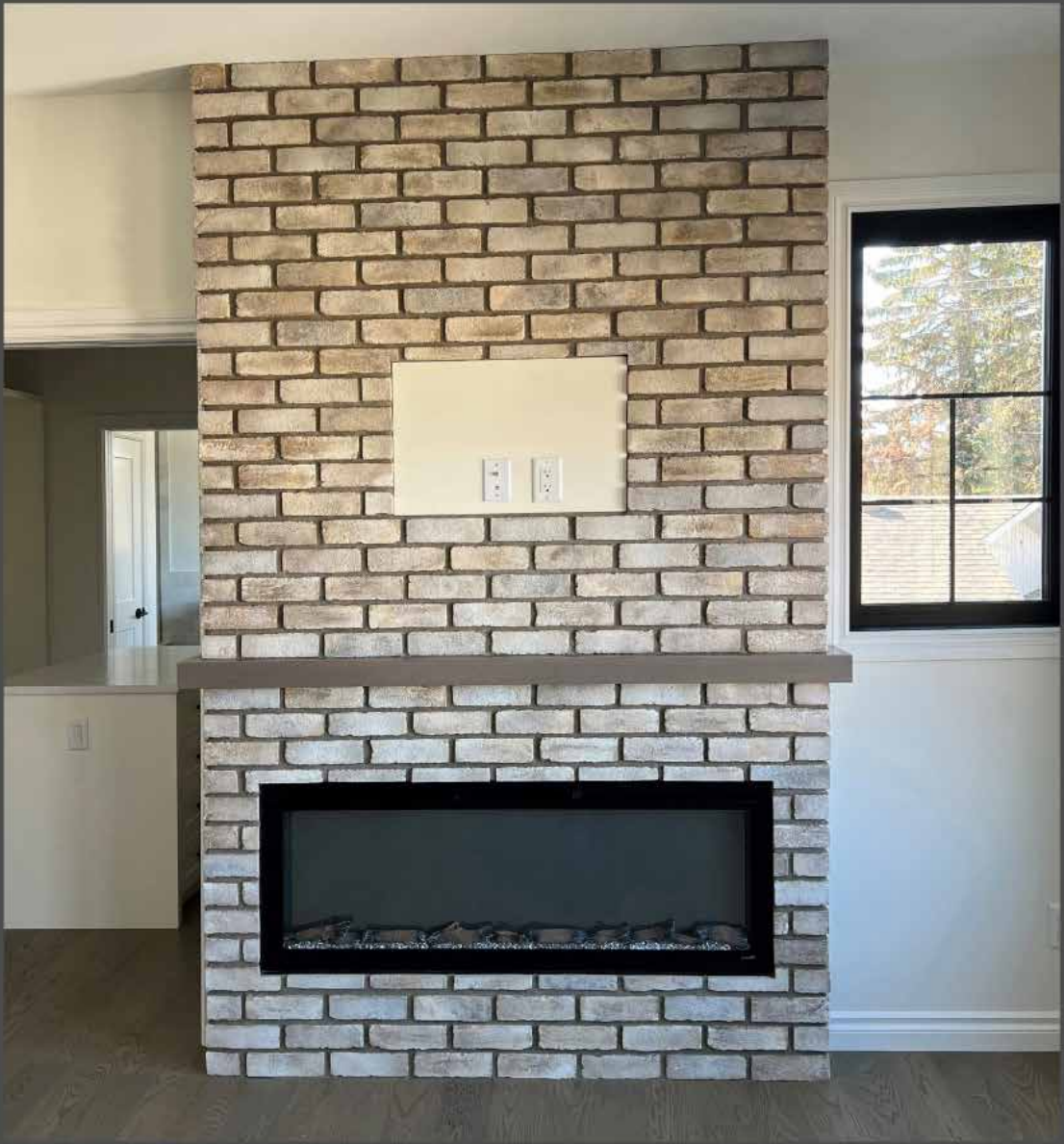

INFILL WHITE BRICK

General Contractor: Kimberly Homes

Masonry Contractor: Golden Boy Masonry

Masonry Supplier: I-XL Building Products

SINGLE FAMILY RESIDENTIAL



LAKEVIEW RESIDENCE

Designer: Dda Architecture Ltd.

Engineer: AM Structural Engineering Ltd. (House)

General Contractor: Waterford Homes Inc.

Masonry Contractor: Stonehouse Masonry

Masonry Supplier: Keel Architectural Products

Engineer Masonry: BBStek Design Ltd.

SINGLE FAMILY RESIDENTIAL



LYALTA

General Contractor: Windsor & Brunello

Masonry Contractor: Tanners Masonry

Masonry Supplier: Select Stone Supply

SINGLE FAMILY RESIDENTIAL



35 MCKENDRICKS POINTE

Masonry Contractor: Tanners Masonry
Masonry Supplier: Stone Concept
Masonry Supplier: I-XL Building Products

SINGLE FAMILY RESIDENTIAL



OCEAN PEARL SLAB FIREPLACE

Designer: Boss Design

Design: Aspen Brick & Stone

Engineer: Acius Engineering

Masonry Contractor: Elite Elevations Masonry

Masonry Supplier: Aspen Brick & Stone

SINGLE FAMILY RESIDENTIAL



POWELL RESIDENCE

Masonry Contractor: Tanners Masonry

Masonry Supplier: Thunderstone Quarries

SINGLE FAMILY RESIDENTIAL



PRIVATE RESIDENCE - CHINOOK PARK, CALGARY

Designer: Elevate Design + Projects Inc.

Masonry Contractor: Jackson Masonry Ltd.

Masonry Supplier: White Cap Supply Canada

Masonry Supplier: Aspen Brick & Stone

SINGLE FAMILY RESIDENTIAL



PRIVATE RESIDENCE - JARVIS BAY

Owner: Stoneworx Masonry and Stucco

Designer: Sorento Custom Homes

General Contractor: Sorento Custom Homes

Masonry Contractor: Stoneworx Masonry and Stucco

Masonry Supplier: White Cap Supply Canada

SINGLE FAMILY RESIDENTIAL



PRIVATE RESIDENCE - LAKEVIEW, CALGARY

Designer: McDowell & Associates Inc.

Designer: Elevate Design + Projects Inc.

General Contractor: Mission Homes

Masonry Contractor: Jackson Masonry Ltd.

Masonry Supplier: White Cap Supply Canada

Masonry Supplier: Aspen Brick & Stone

Photographer: Klassen Photography

SINGLE FAMILY RESIDENTIAL



PRIVATE RESIDENCE - LETHBRIDGE

Designer: Stone Gate Design Build Inc.

General Contractor: Stone Gate Design Build Inc.

Masonry Contractor: Jackson Masonry Ltd.

Masonry Supplier: White Cap Supply Canada

SINGLE FAMILY RESIDENTIAL



PRIVATE RESIDENCE 2 - LETHBRIDGE

Designer: McDowell & Associates Inc.

General Contractor: Stone Gate Design Build Inc.

Masonry Contractor: Jackson Masonry Ltd.

Masonry Supplier: White Cap Supply Canada

SINGLE FAMILY RESIDENTIAL



PRIVATE RESIDENCE - MILLARVILLE

Designer: Ellard Design Group

General Contractor: Rocky Point Custom Homes Ltd.

Masonry Contractor: Jackson Masonry Ltd.

Masonry Supplier: Aspen Brick & Stone

Klassen Photography: Klassen Photography

SINGLE FAMILY RESIDENTIAL



PRIVATE RESIDENCE - POSTHILL, CALGARY

Designer: Inertia Residential Design

Designer: Elevate Design + Projects Inc.

Engineer: Silver Tree Structural Ltd.

Masonry Contractor: Jackson Masonry Ltd.

Masonry Supplier: I-XL Building Products

Photographer: Klassen Photography

SINGLE FAMILY RESIDENTIAL



PRIVATE RESIDENCE - WILDWOOD, CALGARY

Designer: Hallett Architects Ltd.

Engineer: Orata Engineering Inc.

Masonry Contractor: Jackson Masonry Ltd.

Masonry Supplier: Rocky Mountain Stone Supply

Photographer: Klassen Photography

SINGLE FAMILY RESIDENTIAL



PRIVATE RESIDENCE BRITANNIA

Owner: Mckena Homes

Designer: Jackson McCormick Design Group

Masonry Contractor: Jackson Masonry Ltd.

Masonry Supplier: White Cap Supply Canada

SINGLE FAMILY RESIDENTIAL



PROSPECT HERITAGE HOME

Designer: Dda Architecture Ltd.

Engineer: Heninger Structural Engineering Ltd.

General Contractor: Waterford Homes Inc.

Masonry Contractor: Brxton Masonry

Masonry Supplier: White Cap Supply Canada

SINGLE FAMILY RESIDENTIAL



PURIFCATI MASONRY HEATER

Owner: Joe Purifcati

Designer: Adorn Masonry

General Contractor: Marcon Construction

Masonry Contractor: Adorn Masonry

Masonry Supplier: Cast Supply

Masonry Supplier: White Cap Supply Canada

SINGLE FAMILY RESIDENTIAL



RIVER PARK RESIDENCE

Designer: Dda Architecture Ltd.

Engineer: MWC Consulting Structural Engineers Inc.

General Contractor: Alec Williams Construction

Masonry Contractor: Cornerstone Masonry

Masonry Supplier: White Cap Supply Canada

Masonry Supplier (Stone): Rocky Mountain Stone Supply

SINGLE FAMILY RESIDENTIAL



ROXBORO RESIDENCE

Designer: Dda Architecture Ltd.

Engineer: GC Engineering Ltd. (House)

General Contractor: Triangle Enterprises Ltd.

Masonry Contractor: Stonehouse Masonry

Masonry Supplier: White Cap Supply Canada

Engineer Masonry: BBStek Design Ltd.

SINGLE FAMILY RESIDENTIAL



SHERWOOD GOLF BUNGALOW

Designer: Angelique Case Interiors

Architect: Boss Design

General Contractor: Carson Built Homes

Masonry Contractor: Kontech Masonry

Masonry Supplier: Aspen Brick & Stone

SINGLE FAMILY RESIDENTIAL



STEIN RESIDENCE

Designer: Baywest Homes

General Contractor: Baywest Homes

Masonry Contractor: Am-Can Masonry

Masonry Supplier: IXL Building Products

Masonry Supplier: Rocky Mountain Stone Supply

SINGLE FAMILY RESIDENTIAL



56 STONEWOOD DALE

General Contractor: Grandscape Homes

Masonry Contractor: Tanners Masonry

SINGLE FAMILY RESIDENTIAL



STRATHEARN RESIDENCE

Designer: Joe Tkalcic

Masonry Contractor: BrickSmiths Masonry

Masonry Supplier: Cast Supply Inc.

SINGLE FAMILY RESIDENTIAL



THEBARN

Owner: Tanners Holdings Inc

Masonry Contractor: Tanners Masonry

Masonry Supplier: Rocky Mountain Stone Supply

SINGLE FAMILY RESIDENTIAL



TIMELESS ELEGANCE KIMBERLY

Owner: Kimberly Homes

General Contractor: Kimberly Homes

Masonry Contractor: Golden Boy Masonry

Masonry Supplier: I-XL Building Products

SINGLE FAMILY RESIDENTIAL



TYNDALL FIREPLACE

Designer: RUFproject

General Contractor: Plaid Shirt Project

Masonry Contractor: Am-Can Masonry

Masonry Supplier: White Cap Supply Canada

SINGLE FAMILY RESIDENTIAL



44 UPLANDS WAY

General Contractor: Braemyn Homes

Masonry Contractor: Tanners Masonry

Masonry Supplier: Aspen Brick & Stone

SINGLE FAMILY RESIDENTIAL



VICKY'S HOMES

Owner: Vicky's Homes

Masonry Contractor: BRK Masonry

Masonry Supplier: Timberstone Distribution

SINGLE FAMILY RESIDENTIAL



VICTOIRE HOME

Designer: Vicky's Homes

Masonry Contractor: BRK Masonry

Masonry Supplier: White Cap Supply Canada

SINGLE FAMILY RESIDENTIAL



WINDERMERE MANOR

Designer: Boss Design

General Contractor: Alair Homes

Masonry Contractor: Denca Construction

Masonry Supplier: Aspen Brick & Stone



**Rundle Rock
Building Stone**
Sold by Kamenka Quarry Ltd.



Rundle Stone
Alberta's Natural Building Stone
Millions of years in the making
*Harvested from the Earth at
Rundle Rock's Boutique Quarry*

403-609-4050 • 98 RUNDLE ROAD
HARVIE HEIGHTS, AB T1W 2W2
rundlerockquarry@gmail.com



Your Amazing Project.
Our Amazing Products.
A Perfect Match!



Congratulations 2024 Winners



More Sizes. More Shapes. More Possibilities.®

INTERSTATE BRICK

interstatebrick.com



JKLMASONRY.CA



AWARD OF EXCELLENCE – PLATINUM

STRUCTURAL MASONRY DESIGN



MANYHORSES HIGH SCHOOL

Owner: Tsuut'ina Nation

**Designer: The Workun Garrick Partnership
Architecture and Interior Design Inc.**

Engineer: Protostatix

General Contractor: Bird Construction

Masonry Contractor: Bearstone Ex Masonry

Masonry Supplier: Cast Supply

AWARD OF EXCELLENCE – GOLD

STRUCTURAL MASONRY DESIGN



BREWERY BUILDING 11

Owner: First Capital Realty

Designer: Dialog

General Contractor: Chandos Construction Ltd.

Masonry Contractor: Scorpio Masonry

AWARD OF EXCELLENCE – SILVER

STRUCTURAL MASONRY DESIGN



ST. LORENZO RUIZ MIDDLE SCHOOL

Owner: Red Deer Catholic Regional Schools

Designer: Group2 Architecture Interior Design Ltd.

General Contractor: Clark Builders

Masonry Contractor: J.R. Masonry Western Ltd.

Masonry Supplier: Expocrete

STRUCTURAL MASONRY DESIGN



4311 COMMERCIAL CENTRE

Owner: 1846614 Alberta Ltd.

Designer: Berry Architecture + Associates

Engineer: ONEC Group

General Contractor: Shunda Consulting & Construction Management Ltd.

Masonry Contractor: J.R. Masonry Western Ltd.

Masonry Supplier: IXL Building Products

Block Supplier: Expocrete

STRUCTURAL MASONRY DESIGN



DR. ANNE ANDERSON HIGH SCHOOL

Owner: Edmonton Public School Board

Designer: BR2 Architecture

General Contractor: Clark Builders

Masonry Contractor: K Hansen Masonry

Masonry Supplier: Expocrete

STRUCTURAL MASONRY DESIGN



ECOLE PERE KENNETH KEARNS SCHOOL ADDITION AND MODERNIZATION

Owner: Elk Island Catholic Separate Regional School Division No. 41

Designer: ONPA Architects

Engineer: BPTEC Engineering Ltd.

General Contractor: Jen-Col Construction

Masonry Contractor: J.R. Masonry Western Ltd.

Masonry Supplier: IXL Building Products

STRUCTURAL MASONRY DESIGN



FATHER LACOMBE SCHOOL REPLACEMENT

Owner: St. Thomas Aquinas Roman Catholic School Division

Designer: Group2 Architecture Interior Design Ltd.

Engineer: Williams Engineering

General Contractor: Shunda Consulting & Construction Management Ltd.

Masonry Contractor: J.R. Masonry Western Ltd.

Masonry Supplier: Cast Supply

Block Supplier: Expocrete

STRUCTURAL MASONRY DESIGN



FIRESIDE SCHOOL

Owner: Rockyview School Division

Designer: BR2 Architecture

General Contractor: Lear Construction

Masonry Contractor: Bearstone Ex Masonry

Masonry Supplier: Expocrete

STRUCTURAL MASONRY DESIGN



GRAND PRAIRIE COMPOSITE HIGH SCHOOL REPLACEMENT

Owner: Grande Prairie School Division
Designer: The Workun Garrick Partnership
Architecture and Interior Design Inc.
Engineer: SPA Engineering
General Contractor: Aman Builders Inc
Masonry Contractor: K Hansen Masonry
Masonry Supplier: White Cap Supply Canada
Masonry Supplier: Expocrete

STRUCTURAL MASONRY DESIGN



HOLY SPIRIT SCHOOL

Owner: Catholic School Board

Designer: S2 Architecture

Engineer: TRL & Associates

General Contractor: CANA Group of Companies

Masonry Contractor: Bearstone Ex Masonry

Masonry Supplier: Expocrete

STRUCTURAL MASONRY DESIGN



LAC LA BICHE COUNTY WASHROOMS AND GAZEBO

Owner: Lac La Biche County

Masonry Contractor: Adorn Masonry

Masonry Supplier: Cast Supply

Masonry Supplier: Expocrete

STRUCTURAL MASONRY DESIGN



MONTGOMERY HIGH SCHOOL REPLACEMENT

Owner: Alberta Infrastructure

Designer: GGA - Architecture

Engineer: TRL & Associates

General Contractor: Lear Construction

Masonry Contractor: BCL Brothers Masonry Contracting

Masonry Supplier: I-XL Building Products

Masonry Supplier: White Cap Supply Canada

STRUCTURAL MASONRY DESIGN



OWL RIVER CAMPGROUND WASHROOMS AND GAZEBO

Owner: Lac La Biche

General Contractor: Lac La Biche County

Masonry Contractor: Adorn Masonry

Masonry Supplier: Cast Supply

Masonry Supplier: Expocrete

STRUCTURAL MASONRY DESIGN



PEAKS HOTEL & SUITES

Owner: Banff Park Lodge

Designer: METAFOR

General Contractor: CANA Construction

Masonry Contractor: Oskar Construction

Masonry Supplier: Thunderstone Quarries

STRUCTURAL MASONRY DESIGN



THE MALCOLM HOTEL

Owner: Spring Creek Mountain Village

Designer: METAFOR

General Contractor: Spring Creek Mountain Village

Masonry Contractor: Oskar Construction

Masonry Supplier: Thunderstone Quarries

BLOCK-TECH INDUSTRIES LTD.

At Block-Tech Industries Ltd, we bring you professional experience and technical expertise to help you realize your most ambitious masonry projects.

Quality craftsmanship, precise execution, personalized service - Call on our team for masonry work that stands the test of time!



www.block-techindustriesltd.ca ■ 403-406-3667
Bay 3, 4608 62 Street ■ Red Deer, AB T4N6T3



Commercial Residential Historical Restoration

In business since 1997

hieland@mayzesmasonry.ca

403-527-2816



titanmasonryltd.ca

Proudly serving southern Alberta since 2007.



Ernie@titanmasonryltd.ca 403-971-1701
Jason@titanmasonryltd.ca 403-360-9153
Laura@titanmasonryltd.ca 403-894-0674

NORTH CAN Construction Ltd

northcanltd.ca



15847-116 Ave NW
Edmonton, Alberta T5M 3W1
780-904-3434
info@northcanltd.ca

AWARD OF EXCELLENCE – PLATINUM

SUSTAINABLE MASONRY CONSTRUCTION



DELIA K-12 REPLACEMENT SCHOOL

Owner: Prairie Land Regional Division #25

Designer: Iwanski Architecture Inc.

Engineer: BEI Engineering 2000 Inc.

General Contractor: Shunda Consulting & Construction Management Ltd.

Masonry Contractor: Block Tech Industries

Masonry Supplier: Cast Supply

AWARD OF EXCELLENCE – GOLD

SUSTAINABLE MASONRY CONSTRUCTION



SIBYLLA KIDDLE SCHOOL

Owner: Calgary Board of Education

Designer: GGA Architecture

Engineer: Entuitive

Masonry Contractor: Gunthers Masonry

Masonry Supplier: Expocrete

Masonry Supplier: I-XL Building Products

AWARD OF EXCELLENCE – SILVER

SUSTAINABLE MASONRY CONSTRUCTION



THE MACLAREN

Owner: Edgar Developments

Designer: Dialog

General Contractor: Clark Builders

Masonry Contractor: Scorpio Masonry

Masonry Supplier: I-XL Building Products

SUSTAINABLE MASONRY CONSTRUCTION



AUBURN BAY SCHOOL

Owner: Calgary Board of Education

Designer: S2 Architecture

Engineer: TRL & Associates

General Contractor: CANA Group of Companies

Masonry Contractor: Gunthers Masonry

Masonry Supplier: Expocrete

SUSTAINABLE MASONRY CONSTRUCTION



FIREPLACE & WOOD BURNING PIZZA OVEN

Designer: Am-Can Masonry

General Contractor: Am-Can Masonry

Masonry Contractor: Am-Can Masonry

SUSTAINABLE MASONRY CONSTRUCTION



KINGSMITH BUILDERS WILLOWS - COCHRANE

Owner: Kingsmith Builders

General Contractor: Kingsmith homes

Masonry Contractor: Nordic Stoneworks

Masonry Supplier: White Cap Supply Canada

Bricklayer: Oxford Masonry

SUSTAINABLE MASONRY CONSTRUCTION



SHRINE CHURCH OF OUR LADY OF THE ROCKIES

Owner: Roman Catholic Diocese of Calgary

Designer: Boruk Ron Architect

Architect: NORR

Engineer: NORR

General Contractor: Modco Structures

Masonry Contractor: Oskar Construction

Masonry Supplier: Rundle Rock Building Stone



The AMC was incorporated in 2011 by the masonry contractors and suppliers of the Masonry Contractors Association of Alberta (MCAA). Our mission is to promote masonry through education, marketing, and technical guidance to improve the sustainability of construction in Alberta through the aesthetic appeal and durability of masonry.

AMC has a robust and dynamic presence in the architectural construction and engineering communities. We are involved in social media, fostering strong relationships and brand awareness. Hosting prominent events such as the Masonry Design Awards, AMC golf tournament and "Bowling with Architects," facilitates valuable connections with the professionals that specify the use of masonry. Hosting booths and speaking at key trade shows, including the AAA Banff Sessions and the CSC Annual Conference, showcase our innovations and support for the construction industry. Collaborations with architecture and engineering departments at various post-secondary institutions in Alberta reflect our dedication to education and industry advancement. AMC provides technical advising and funding for MITACS/NSERC scholarships, which support market-driven research projects like thermal modeling of masonry, adhered masonry veneers bond strength, masonry tall walls, and shelf-angle testing. These academic collaborations ensure masonry remains innovative, exciting, and relevant in the evolving construction industry. We also support scholarships for Architectural Technologists at SAIT and NAIT, as well as research for the Architectural Program at the University of Calgary.

AMC provides free technical advice to a diverse clientele—owners, designers, spec writers, cost consultants, and contractors. This is a core part of our mission. We develop and present accredited educational seminars, popularly known as "lunch and learns," to disseminate crucial knowledge and best practices. Additionally, we create valuable technical aids, including the design of shelf angles, and produce detailed 2D and 3D masonry designs for our website. Our marketing initiatives in this area extend to writing insightful articles for trade publications such as Construction Canada Magazine, ABEC, and IIBEC magazines.

Our government relations advocacy involves engaging with city planners, town and city councillors, Provincial MLAs, and Federal Government MPs to secure architectural controls that mandate the use of masonry, reinforcing our commitment to the industry's growth and sustainability.

Through the efforts of our board and staff AMC will continue to promote, support and grow the masonry industry in Alberta.



Alberta Legislature, Edmonton

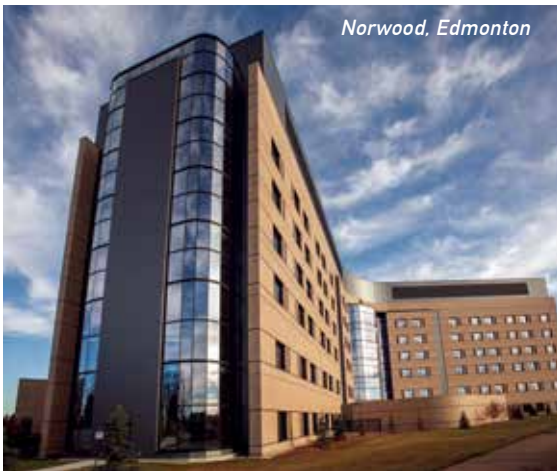

Norwood, Edmonton



Manchester Square, Edmonton

EDMONTON
780-447-1682



**SCORPIO
MASONRY**
WWW.SCORPIOMASONRY.COM

CALGARY
403-906-1682

RESTORATION • COMMERCIAL • MULTI-FAMILY
Bringing quality, innovation and expertise to all our projects



*Dentistry Pharmacy Bldg,
U of A, Edmonton*



CANADIAN CONCRETE MASONRY
PRODUCERS' ASSOCIATION

DID YOU KNOW?

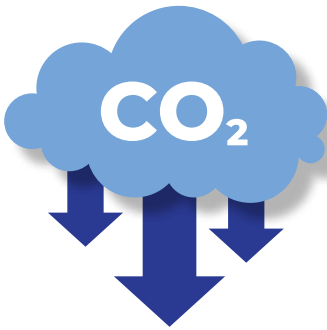

CONCRETE BLOCK
**PASSIVELY &
PERMANENTLY**
SEQUESTERS CARBON

ASK US ABOUT IT!



Learn more about us:

ccmpa.ca

✉ information@ccmpa.ca

